

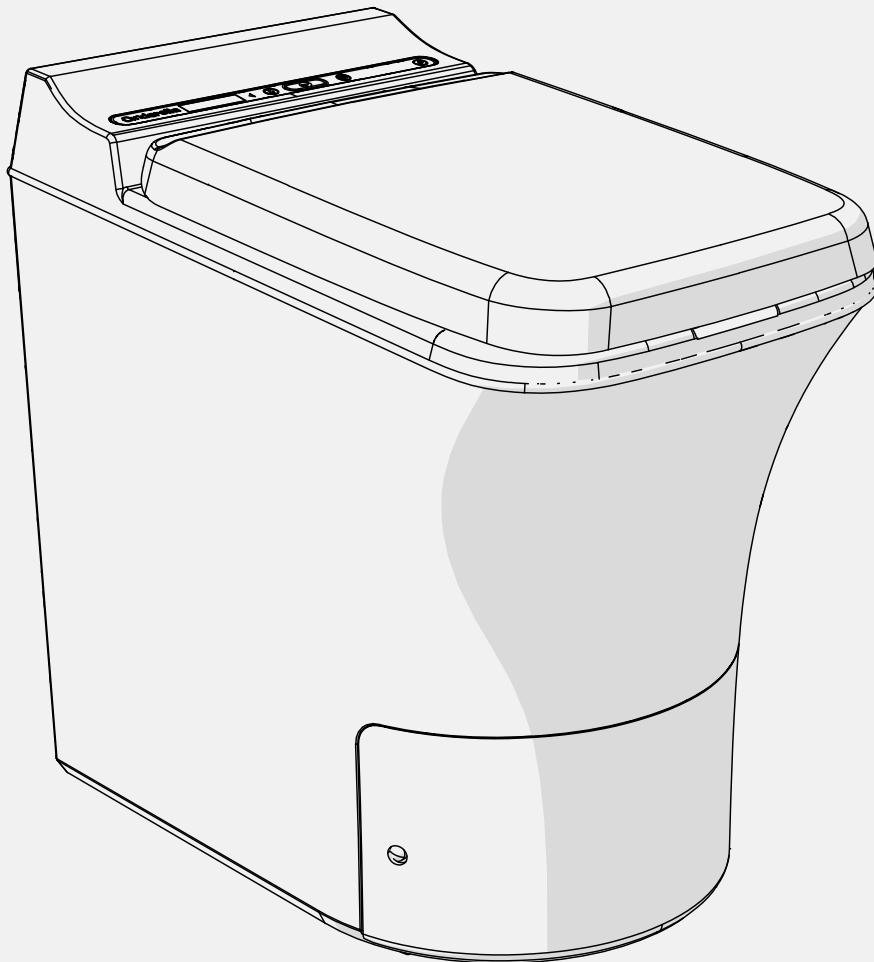

Cinderella[®]
Incineration Toilets

CINDERELLA FREEDOM
CINDERELLA FREEDOM AUS/NZ
Product manual



CONTENTS

1. GENERAL SECTION	3
1.1 INTRODUCTION	3
1.2 APPLICATION ACCORDING TO REGULATIONS	3
1.3 OPERATING INSTRUCTIONS GUIDE	3
1.4 LIMITATION OF LIABILITY	3
1.5 LISTINGS AND CERTIFICATIONS	3
1.6 GENERAL SAFETY INSTRUCTIONS	4
1.7 APPLIANCE RATING PLATE	5
1.8 CINDERELLA ONLINE	5
1.9 UNPACKING THE TOILET AND ACCESSORIES	5
2. INSTALLATION SECTION	6
2.1 SECURING THE TOILET TO THE FLOOR	6
2.2 MEASUREMENT SPECIFICATIONS CINDERELLA FREEDOM	7
2.3 FLUE PIPE INSTALLATION	8
2.3.1 FLUE PIPE SPECIFICATION	9
2.3.2 HORIZONTAL FLUE PIPE SPECIFICATIONS	10
2.3.3 VERTICAL FLUE PIPE SPECIFICATIONS	11
2.4 INLET AIR	12
2.5 GAS INSTALLATION	13
2.6 ELECTRIC CONNECTION	14
2.7 CHECKLIST TO VERIFY THE COMPLETE INSTALLATION	14
2.8 PERFORMANCE TEST TO VERIFY THE SYSTEM FUNCTIONALITY	15
3. USER SECTION	16
3.1 INTENDED USE AND HANDLING	16
3.2 GENERAL SAFETY	16
3.3 SAFETY WHEN OPERATING WITH GAS	16
3.4 SAFE OPERATIONS	17
3.5 CINDERELLA FREEDOM SAFETY FEATURES	17
3.6 IMPORTANT USER INFORMATION	18
3.7 THE CONTROL PANEL	19
3.8 USING THE CINDERELLA FREEDOM TOILET	20
3.9 OPERATING THE FRONT COVER AND ASH CONTAINER	21
3.10 APPLIANCE ORIENTATION	22
4. GENERAL MAINTENANCE INSTRUCTIONS	22
4.1 END PRODUCT CHARACTERISTICS	23
4.2 CUSTOMER MAINTENANCE	23
4.2.1 EMPTYING AND CLEANING THE ASH CONTAINER	23
4.2.2 STEAM-CLEANING THE CATALYTIC CONVERTER	24
4.2.3 INSPECTING THE CATALYTIC CONVERTER	25
4.2.4 CLEANING THE BOWL	25
4.2.5 MAINTENANCE DURAVENT FLUE PIPE SYSTEM	26
4.3 PROFESSIONAL MAINTENANCE	26
4.3.1 RINSING THE EXHAUST SYSTEM AND CATALYTIC CONVERTER	26
5.0 TROUBLESHOOTING AND FAQ	27
5.1 TROUBLESHOOTING TABLE	28
6. REPAIRS AND SPARE PARTS	29
6.1 SPARE PARTS LIST	29
6.2 APPLIANCE PROCESS OVERVIEW	30
6.3 TECHNICAL ORIENTATION	30
6.4 WIRE DIAGRAM	31
7. WARRANTY	31

1. GENERAL SECTION

1.1 INTRODUCTION

It is essential to ensure proper ventilation in accordance with the guidelines in this manual to guarantee the functionality of your new Cinderella toilet. Improper installation may cause malfunction, wear and/or odours and will void the warranty. When installing the appliance, the technical and administrative regulations of AS/NZS 5601.1 and the local authority where the toilet is installed must be adhered to. ULPG cylinders must be installed in accordance with AS/NZS 5601.1 or AS/NZS 596.

1.2 APPLICATION ACCORDING TO REGULATIONS

This appliance is designed to burn bodily waste products and small sanitary products such as toilet paper and baby or face wipes. This appliance must not be installed in a mobile or portable installation (e.g. mobile home, mobile shed, recreational vehicle or caravan).

1.3 OPERATING INSTRUCTIONS GUIDE

Please read this instruction manual carefully before installation and first use. Store these instructions in a safe place so you can refer to them when required. If you pass on the product to someone else, hand over this instruction manual along with it.

These instructions provide you with the necessary guidance for proper installation, handling and maintenance of the product. It is important that both the installer and the user familiarise themselves with the instructions given in this manual. The manual also contains information on professional maintenance and any necessary information for service and repairs.

1.4 LIMITATION OF LIABILITY

The manufacturer accepts no liability for damage in the following cases:

- Faulty installation or connection
- Damage to the product resulting from mechanical factors and/or incorrect connection voltage
- Alterations to the product without express permission from the manufacturer
- Use for purposes other than those described in the operating manual
- Non-observation of the operating and maintenance instructions
- Application not in accordance with the regulations or provisions
- Use of non-original bowl liners and spare parts

1.5 LISTINGS AND CERTIFICATIONS

The Cinderella Freedom AUS/NZ has been extensively tested by Underwriters Laboratory in accordance with the Global-Mark certification scheme. The toilet is tested and certified to the Gas Safety standard AS/NZS 5263.0.



1.6 GENERAL SAFETY INSTRUCTIONS



WARNING!

Safety instruction: Failure to observe this instruction could cause fatal or serious injury.



CAUTION!

Safety instruction: Failure to observe this instruction could lead to injury.



NB!

Failure to observe this instruction could cause material damage and impair the function of the product.



NOTE!

Supplementary information for operating the product.



WARNING!

- Do not spray aerosols in the vicinity of this appliance while it is in operation.
- Do not use or store flammable materials in or near this appliance.
- Do not place articles on or against this appliance.
- Do not modify this appliance..



WARNING!

- Do not operate the incinerating toilet if it is visibly damaged.
- If the DC power cable for this toilet is damaged, it must be replaced by the manufacturer, customer service or a similarly qualified person in order to prevent safety hazards.
- Never use a naked flame to check the toilet gas connections for any leakage.
- This toilet may only be repaired by qualified personnel. Inadequate repairs may cause serious hazards.
- Only use ULPG gas (not natural gas or auto LPG).
- Only operate the toilet with the pressure shown on the type plate on the back of the toilet.



CAUTION!

- Danger of crushing! Do not place your hand on the hinge or underneath the toilet seat and lid while open, as there is no soft-close function on the lid and seat.
- Do not empty the ash container when hot.
- Before activating, ensure that the power supply line and plug are dry.







NB!

- During transport, only hold the toilet by the toilet shell. Never hold the toilet by the gas connection, power cord, front cover, lid or seat or exhaust outlet.
- Check that the voltage specification on the type plate is the same as that of the energy supply.
- Only use power cables with a suitable cross section.
- Danger of overheating! Always ensure sufficient ventilation so that the heat and emissions generated during incineration can dissipate from the flue pipe. Ensure proper air flow for the system. Always ensure sufficient ventilation into the room where the toilet is installed. Make sure that the toilet is sufficiently far away from walls or other objects so that air can circulate.

1.7 APPLIANCE RATING PLATE

The appliance rating plate can be found on the back plate of the incineration toilet. From this plate you can read the model identification, serial number, toilet ratings and support detail. You will need these details whenever you contact the customer service centre or when ordering spare parts.

 Cinderella Eco Group Norway Australian subsidiary: Cinderella Eco Australia Pty Ltd Sydney, New South Wales 2000 For sales/support visit: www.cinderellaeco.com	Appliance Specifications VOLTAGE..... 12V DC CURRENT..... 4 A FAN BLOWER..... 12V DC GAS TYPE:..... U LPG GAS SUPPLY PRESSURE: 2.75 kPa TOTAL GAS CONSUMPTION..... 9.8 MJ/h INJECTOR / ORFICE SIZE 1 mm CAPACITY..... 4 PEOPLE PR. HOUR YEAR OF MANUFACTURING..... 2021	 Global-Mark.com.au® ID: GAS-106479-001	
	CINDERELLA MODEL: FREEDOM ANZ SERIAL: 2123 600028	RIGID PIPE CONNECTION ONLY! SUITABLE ONLY FOR INDOOR INSTALLATION! DO NOT OPERATE THIS APPLIANCE BEFORE CHECKING FOR GAS LEAKS! SEE WARNING LABEL WITH THIS ICON IN OWNER'S MANUAL FOR ADDITIONAL INFORMATION 	

1.8 CINDERELLA ONLINE

Register your Cinderella

After registration you may receive relevant information about our products and available support systems. In the event of theft, registered toilets will be in our manufacturer database.

Download documentation

You can download product documentation from our online documentation centre, where you will find owner manuals, service manuals and a Disassembly of Waste Electrical and Electronic Equipment (WEEE) manual.

Service and spare parts

Select country of origin and receive a list of local dealers where you can obtain service and spare parts.



1.9 UNPACKING THE TOILET AND ACCESSORIES

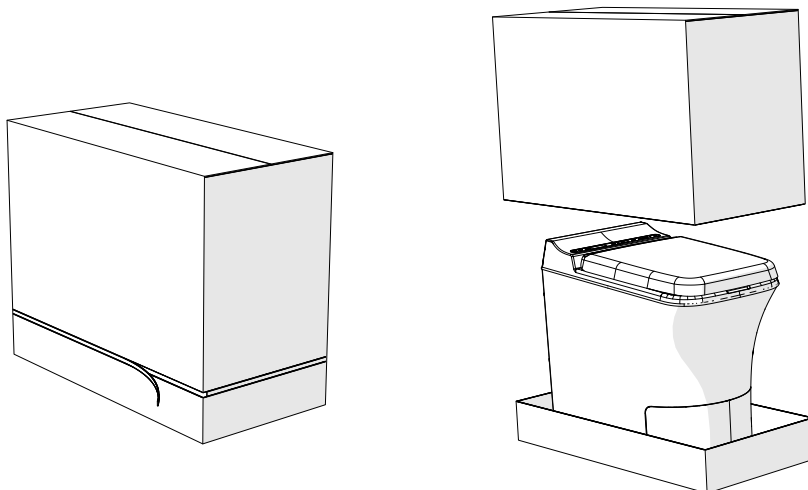

NOTE!

- When unpacking the Cinderella Freedom appliance use the pre-fixed strip on the bottom of the box. Release the strip all around the box and lift up the box.
- The contents of the box are loose inside the box and it is therefore important to unpack the toilet in a place where you have control over items that may fall out.

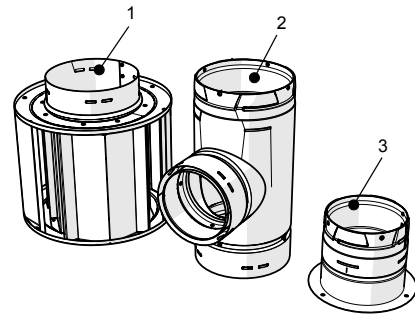
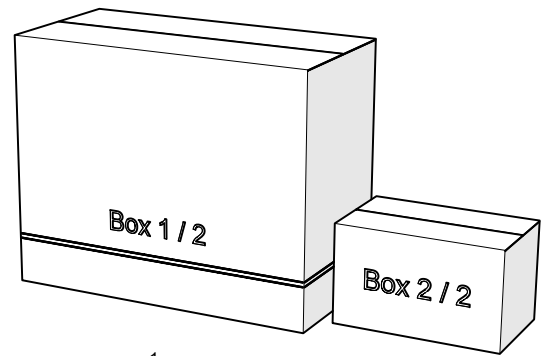
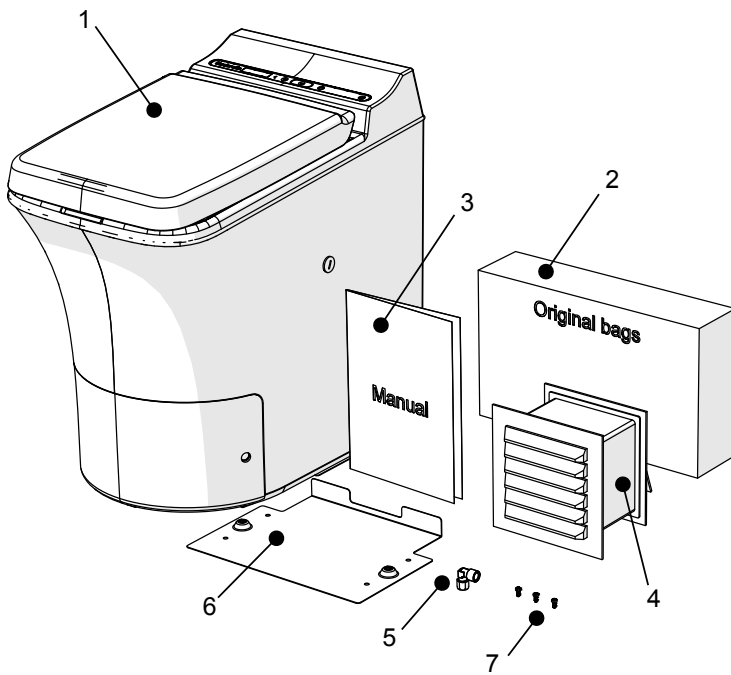

Box 1/2	Cinderella Freedom ANZ	Qty
1	Cinderella Freedom ANZ	1
2	Bowl liners	1
3	Product manual	1
4	Vent duct	1
5	Gas fittings	2
6	Docking station	1
7	Screws 3,5 mm	3

Box 2/2	Installation Kit	Qty
1	Flue terminal w/ spark arrestor 5"	1
2	Reduction Tee 5x4"	1
3	Cinderella Adapter	1

2. INSTALLATION SECTION



NOTE!

This appliance must be installed by a qualified plumber /gas fitter who can provide a certificate of compliance in accordance with AS/NZS 5601.1. It is essential to ensure proper ventilation in accordance with the guidelines in this manual to guarantee the functionality of your new Cinderella toilet. Improper installation may cause malfunction, wear or odours and will void the warranty.

Read each section carefully before starting the installation of the toilet. Always make sure that the work is carried out by professionals in accordance with local regulations.

2.1 SECURING THE TOILET TO THE FLOOR

It is essential to secure the toilet to the floor, and the Cinderella Freedom is therefore delivered with a custom docking station to make this possible. It is important to be sure of the location of the toilet before fastening the docking station to the floor. To install the docking station and toilet;

1. Remove the front cover
2. Cut away the transport safety strip, securing the ash container.
3. Removing the ash container, see page 18 for instructions operating the ash container.
4. Remove the two rear screws that secure the toilet to the shell, using two 10mm wrenches. It will be necessary to hold on to the top while turning from the bottom, hold on to the screws.
5. Place the toilet on the docking and find the desired positioning of the appliance, make a mark on the floor to secure the location of the toilet. Then remove the toilet and fasten the docking to the floor.

6. Place the toilet back the docking and fasten the toilet by crewing back the screws you released earlier from the top of the appliance bottom plate and into the docking.

1

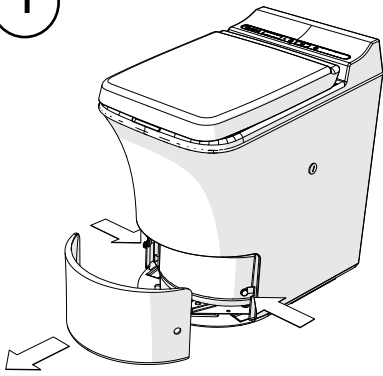

2

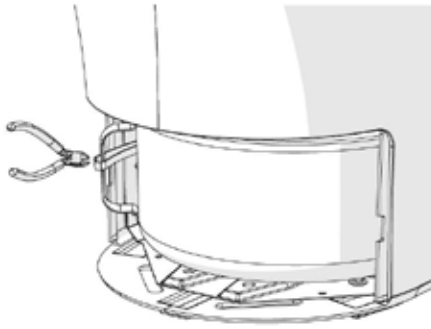

3

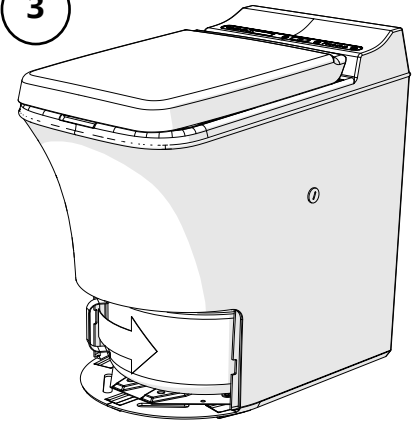

4

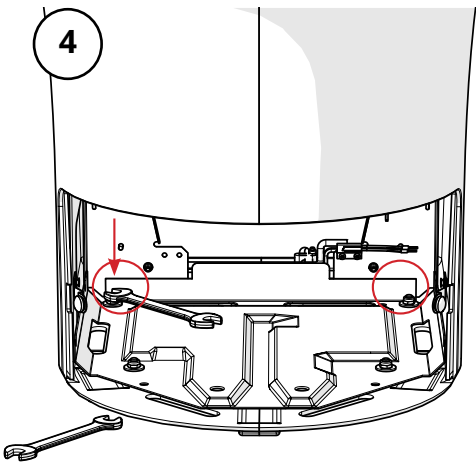

5

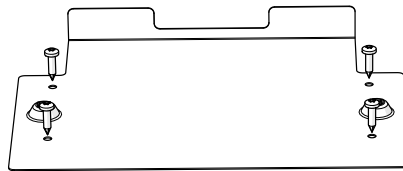

6

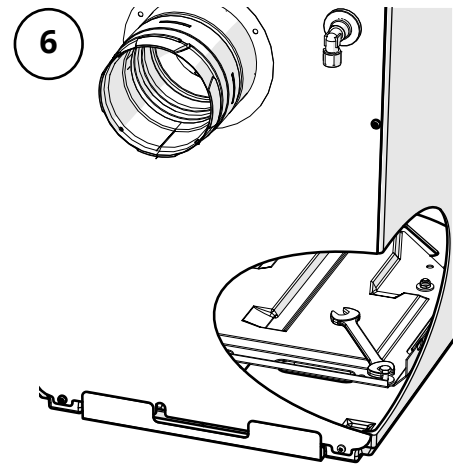

2.2 MEASUREMENT SPECIFICATIONS CINDERELLA FREEDOM

SPECIFICATIONS CINDERELLA FREEDOM	
Seated height	540 mm
Height	600 mm
Width	390 mm
Depth	590 mm (adapter 698mm)
Ventilation outlet	110 mm
Weight	34 kg

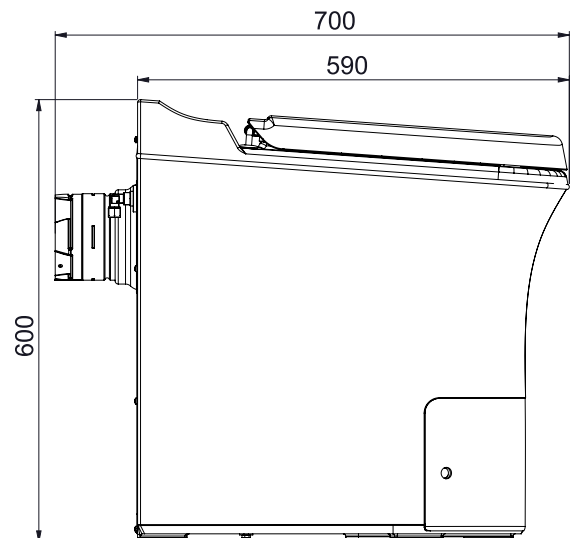
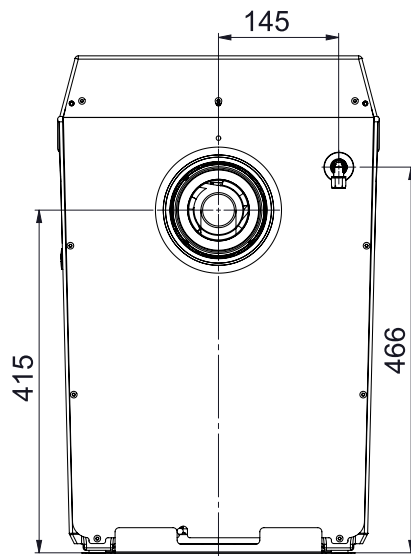
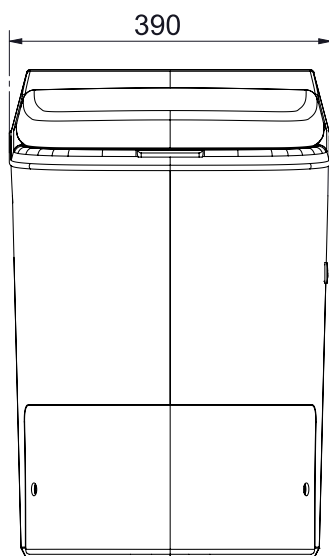

2.3 FLUE PIPE INSTALLATION



NB!

- This appliance must be installed in accordance with AS/NZS 5601.1.
- This appliance must be installed with DuraVent flue pipes, materials must comply with AS/NZS 5601.1.
- This appliance must not be installed in a mobile or portable installation (e.g. mobile home, mobile shed, recreational vehicle or caravan).
- This appliance must not be installed in locations with other air-dependent equipment that could adversely affect the system, such as ventilators or open fire sources.
- This appliance must only be installed by a licensed/authorised person.
- The toilet must be placed on a firm and level base.
- Your Cinderella Freedom incinerating toilet can be installed on a heated floor.
- This appliance must be secured to the floor (see section 2.1 of this manual).
- When installed in environments where condensation may accumulate, adequate condensation draining must be installed.
- The T-bend must be accessible when installed, so that the drainage pipe can be rinsed, and the flue pipe cleaned.



CAUTION!

Before cutting any holes, always check that you will not cut any electrical wiring or water pipes.



NOTE!

- This appliance is designed and certified to be installed with DuraVent's Type B Gas Vent system. For detailed instruction on how to install the flue pipes, tolerances and flue pipe specifications please refer to DuraVent's installation manuals, which can be downloaded from their website: duravent.com/installation-instructions/
- This manual refers to a selection of pipes and accessories from DuraVent's type B system, which fit the special parts supplied with the toilet. It is important to familiarize yourself with the various components and restrictions, in order to achieve the best possible installation and correct product functionality.

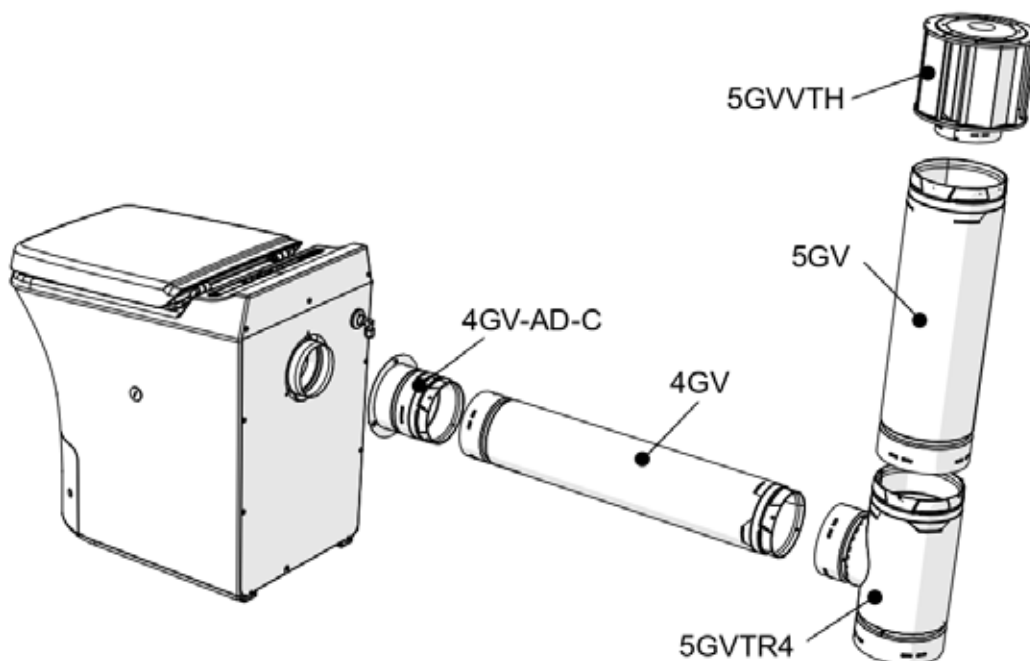

2.3.1 FLUE PIPE SPECIFICATION



NOTE!

- When installing the Cinderella Freedom appliance, it is required to use 4 " pipes for horizontal pipe section, and 5 " pipes for vertical pipe section. This is to preserve an optimal flow effect and ensure good product functionality.
- The appliance is delivered with specially adapted parts from DuraVent: adapter, Increaser tee and flue terminal, to be used upon installation of the product. It is important to calculate the length of vertical and horizontal pipe sections in accordance with local regulations and the instructions given in this manual.
- The DuraVent Type B round pipes are designed with a screw coupling system which makes it easy to rotate the various parts together, but this means that you cannot cut the pipes to the desired length. It is therefore important to look at the instructions and pipes lengths as set out in this manual, and calculate which parts that are needed for the installation of the toilet.

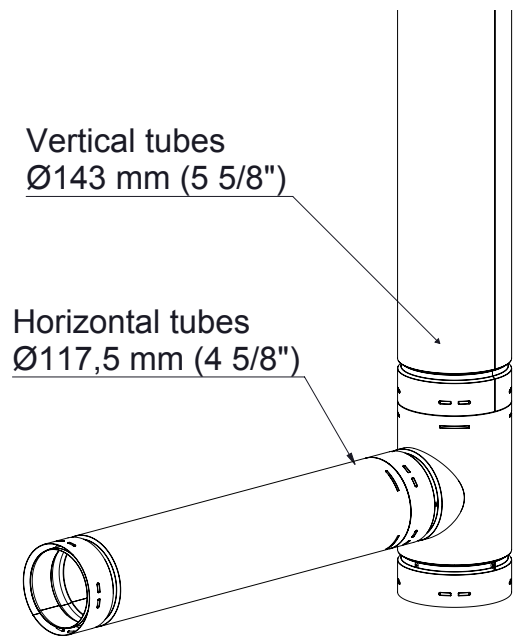

When installing the pipes, it is important to first assemble the tee and horizontal pipe length, before mounting the adapter to the toilet. This is to ensure that you get the correct starting point for the vertical pipe. When you have the desired positioning of your pipes, you simply mount the adapter to the device by marking the hole pattern on the back wall. Remove the adapter and drill the holes (3 mm) according to the markings, fasten the adapter using the 3,5 mm screws supplied with the appliance.

- Rotate horizontal pipe onto the reduction tee
- Rotate adapter onto the horizontal pipe
- Attach adapter to the appliance
- Install the vertical pipes and flue terminal cap

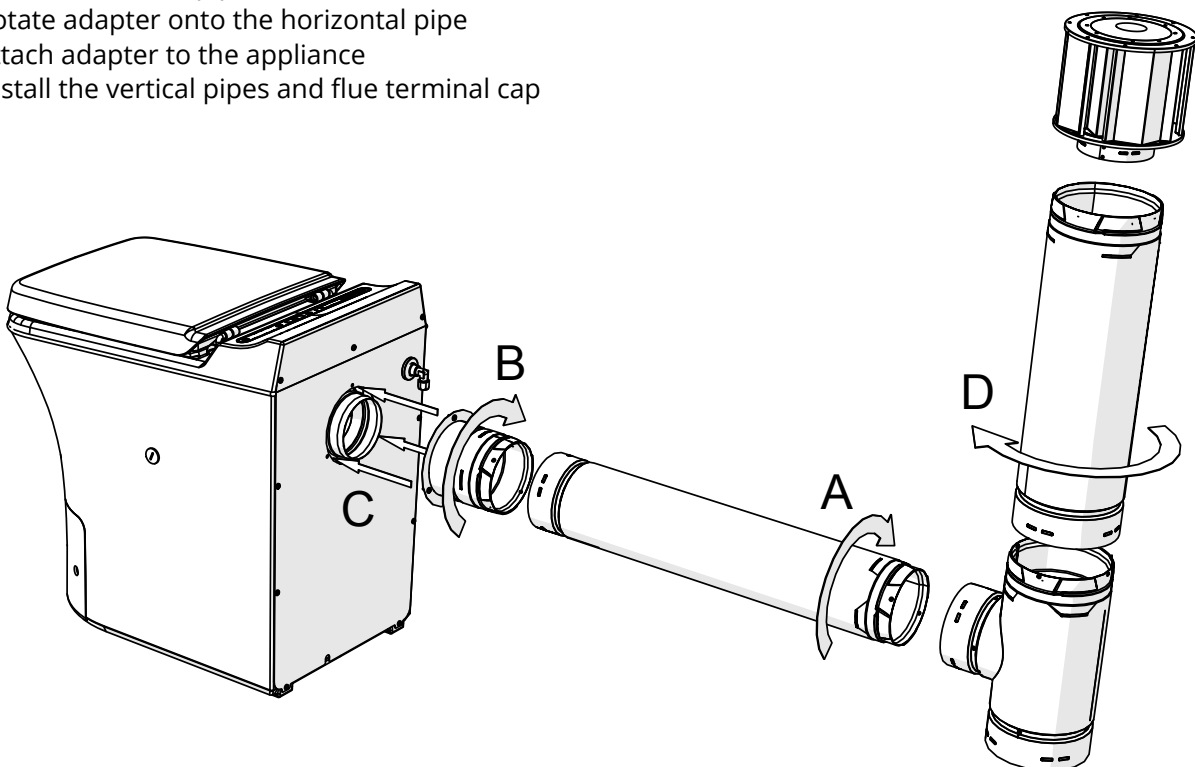

2.3.2 HORIZONTAL FLUE PIPE SPECIFICATIONS

For specifications on horizontal flue pipe installation, see illustration as presented below. The table is used to calculate the distances and possible variants based on a selection of components from the Type-B system.

DURAVENT TYPE B - ROUND PIPES (HORIZONTAL SECTION)						
Part.no	LENGTH		OUTER DIAMETER		INNER DIAMETER	
	INCHES	MM	INCHES	MM	INCHES	MM
4GV06	6	152	4 5/8	118	4	102
4GV24	18	458	4 5/8	118	4	102
5GVTR4	Reduction tee 5 inch to 4 inch					



NOTE!

The outer diameter of the DuraVent pipes for horizontal is 118mm , this will have to be taken into consideration if planning a through-the-wall installation. Installations through-the-wall will have to be done in accordance with the DuraVent installation instructions and AS/NZS 5601.1.

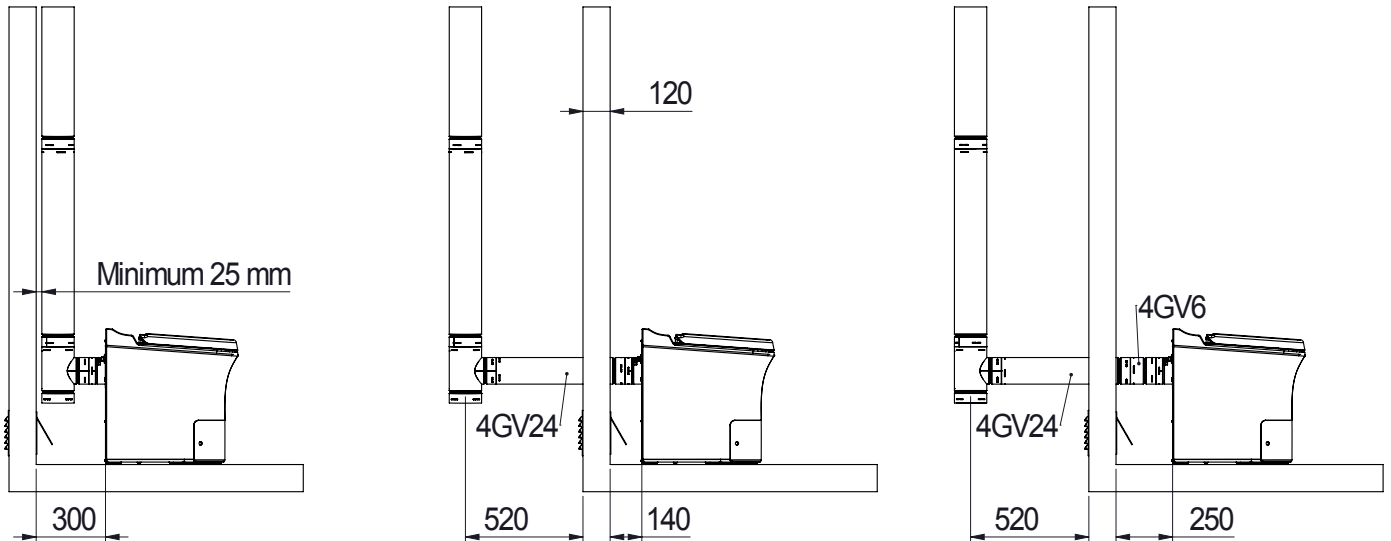

NB!

The horizontal pipe section should be no longer than 1000 mm

2.3.3 VERTICAL FLUE PIPE SPECIFICATIONS

For specifications on vertical flue pipe installation, see illustration as presented below. The table is used to calculate the distances and possible variants based on a selection of components from the Type-B system.

DURAVENT TYPE B - ROUND PIPES (VERTICAL SECTION)						
PART.NO	LENGTH		OUTER DIAMETER		INNER DIAMETER	
	INCHES	MM	INCHES	MM	INCHES	MM
5GV12	12	305	5 5/8	143	5	127
5GV18	18	458	5 5/8	143	5	127
5GV36	36	915	5 5/8	143	5	127

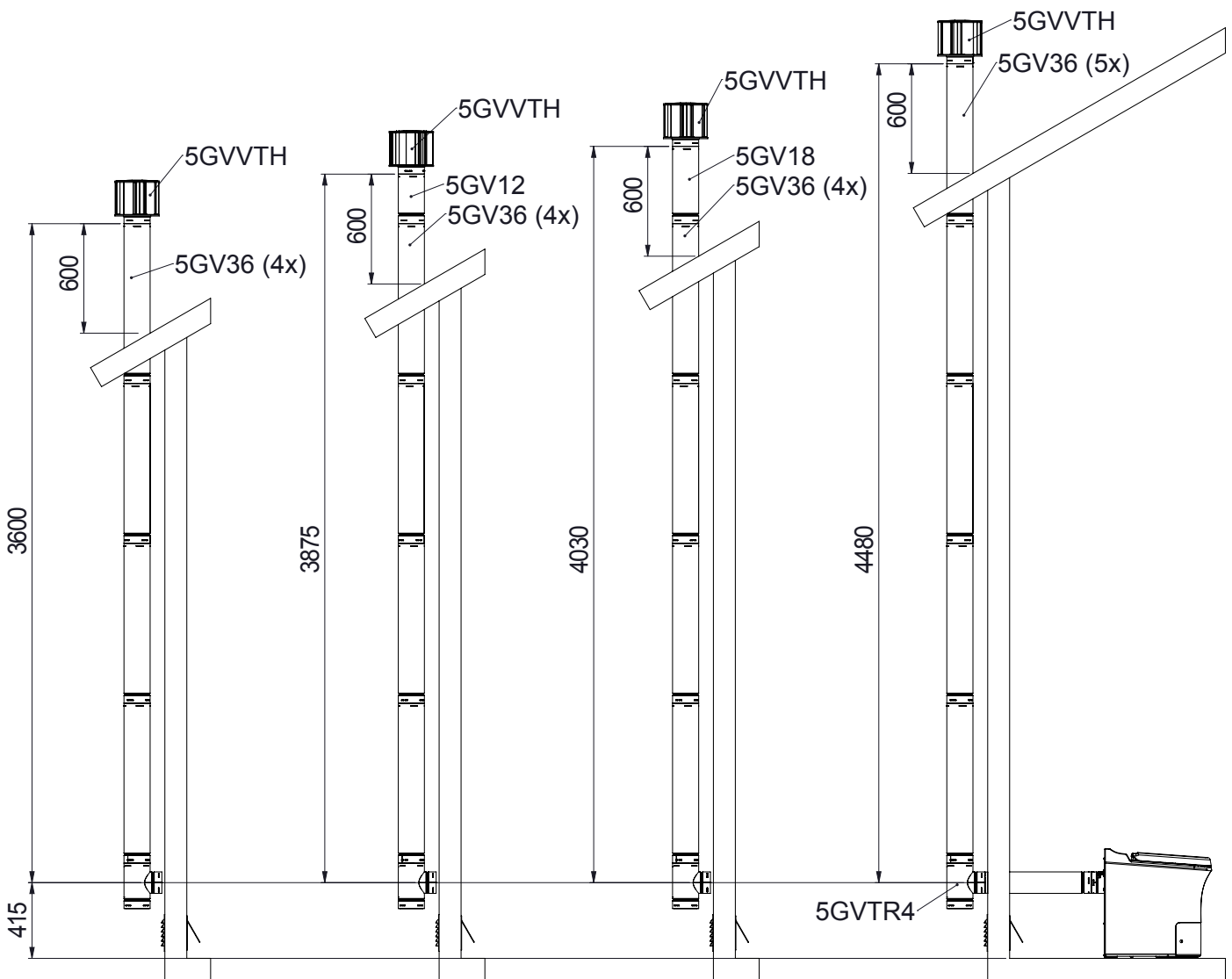

NB!

- The vertical pipe section should be no longer than 4500mm (4.5m)
- NO BENDS
- The flue termination should be no less than 1000mm from the roof surface

2.4 INLET AIR

It is required to install adequate venting in accordance with AS/NZS 5601.1. The air inlet vent should preferably be installed as close to the Cinderella toilet as possible, to ensure a good air supply to the toilet and reduce the environmental impact in the toilet room. It is important that there are no other air-dependent installations used at the same time as the toilet, e.g. an extractor fan or fireplace. The Cinderella Freedom toilet draws air mainly from the underside of the toilet. It is therefore possible to have the air intake underneath the toilet. This allows you to insulate the air as much as possible in the toilet and minimise the environmental impact in the toilet room.



NB!

The inlet vent's minimum dimensions must be 160 mm (diameter)/ 201 cm². We recommend that you use the supplied vent.

- The vent must be open at all times. Remember to clean the vent at regular intervals.
- Make sure that there is no conflict between the toilet's air supply and other installations, such as a fireplace or extractor fan.
- Do not use a separate ventilation fan or similar to extract air from the room where the toilet is installed when using the Cinderella Freedom toilet.
- If you have open ventilation under the toilet, it may be advisable to use a mesh over the hole to keep insects and vermin from entering the toilet. Make sure that the mesh is not too fine as this will impede the air flow.

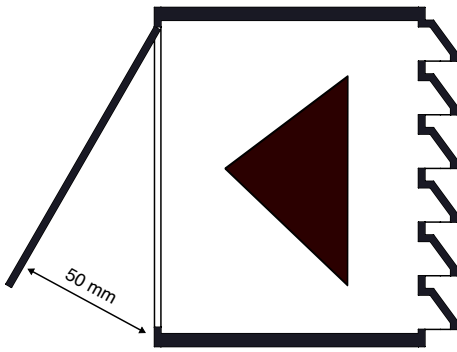

NOTE!

The air inlet vent must always remain open when using the Cinderella toilet.



NOTE!

If the installed air vent has an adjustable opening, always make sure to leave it open by a minimum of (50 mm) when operating the toilet.

2.5 GAS INSTALLATION

This Appliance must be installed by a qualified plumber /gas fitter who can provide a certificate of compliance in accordance with AS/NZS 5601.1. This appliance is designed to be used with ULPG gas and is to be installed with rigid piping only.



CAUTION!

- This toilet must only be connected to the gas supply by an authorised person in accordance with the technical and administrative regulations of the country in which the toilet is installed, i.e. AS/NZS 5601.1.
- Only operate the toilet at the pressure shown on the type plate on the back of the toilet.
- Only operate the toilet with the type of gas shown on the type plate on the back of the toilet.
- The toilet is suitable only for indoor installation

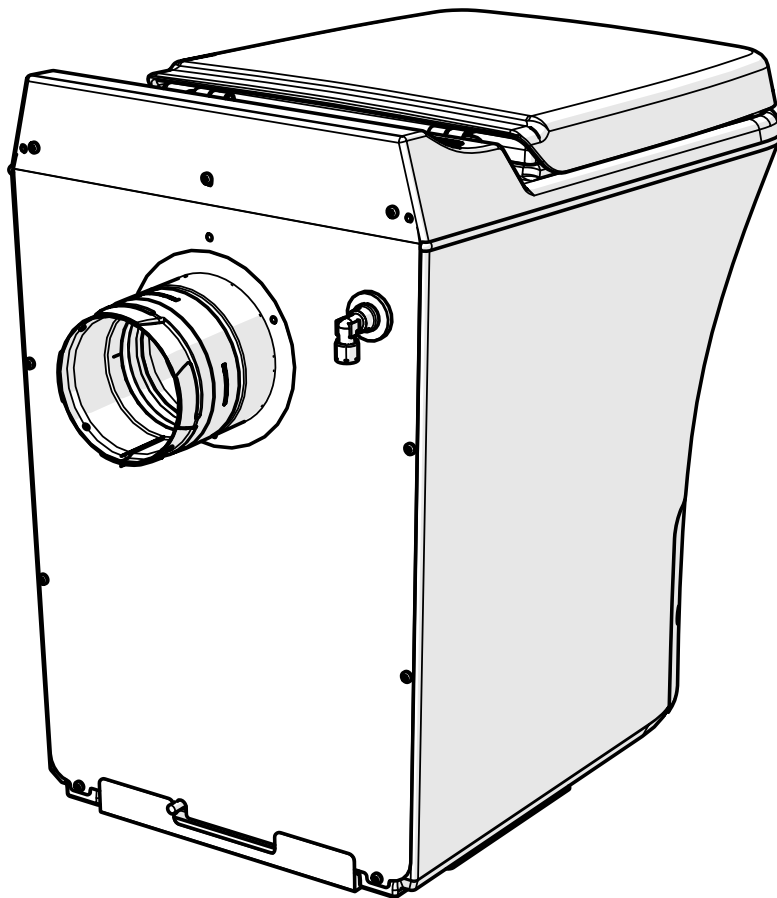

SPECIFICATIONS	VALUE	NOTES
Fuel consumption	9.8 MJ/h	
Inlet gas pressure	2.75 kPa	
Gas type	ULPG	
Gas connection appliance	¼" NTP female	
Male straight increaser threaded fitting	¼" NTP to ¼" BSP	Delivered with appliance
Elbow 90 degree angled threaded fitting	¼" BSP to ½" BSP	Delivered with appliance
Gas installation	Rigid pipes only	In accordance with AS/NZS 5601.1.
Orifice size	1 mm	

2.6 ELECTRIC CONNECTION

The correct voltage, frequency and amperage must be supplied to the appliance from a dedicated, earthed circuit that is protected by a properly sized circuit breaker. The proper voltage, frequency and amperage are listed in this manual, and on the product rating plate on the back of the toilet. Please note: This toilet requires a 12V 4A DC supply. If you require to operate it from a 240V AC power point (GPO) please request the approved power supply from your dealer.

Power requirements	INPUT	CURRENT	FUSE
	12V DC (11 – 14.4V)	4 A	10 A
Power consumption	HIBERNATION MODE	STANDBY MODE	INCINERATING MODE
	0.005 A	0.09 A	1.3 A
Connection polarity	CROSS SECTION	POSITIVE	NEGATIVE
	2 mm ²	Red	Black

The respective negative and positive cables of the DC connection must not be joined to one another in a camper, as this can cause electrical interference and damage to electrical components. The 12V supply must be connected on its own circuit direct to the battery, with a 10 A fuse at the start of the circuit. Use the 12V wire guide to calculate the correct cable size according to the cable length.

12V WIRING GUIDE						
Amps	1 m	2 m	5 m	6 m	8 m	10 m
4	2 mm ²	2 mm ²	2 mm ²	4 mm ²	4 mm ²	4 mm ²

When connecting the toilet to the mains DC power, take the following into consideration:

- Make sure the cable has sufficient current rating for the expected load in the circuit, including a margin of safety.
- Make sure the cable cross section is dimensioned for the intended cable run length, and that the cable will not cause the voltage to drop.
- Always check the polarity of the cables before connecting as reverse polarity connection is not covered under warranty.



NOTE!

- The connection cable must be laid in such a way that it does not come into contact with sharp edges.
- Changes to the internal electrical installation or the connection cable must be performed by a professional tradesman or a similarly qualified person in order to prevent safety hazards.

2.7 CHECKLIST TO VERIFY COMPLETE INSTALLATION

CONTROL ITEMS	CONFORMANCE
The complete installation is in accordance with AS/NZS 5601.1	
The appliance is properly mounted to the floor	
The gas connection is in accordance with the specifications on the appliance rating plate	
The appliance is installed with rigid gas pipes	
The appliance is powered with 12V DC, min. 4A	
The appliance is vented with DuraVent flue pipes	
The supplied DuraVent flue terminal is used on the top of the flue pipe	
The flue pipe is no longer than 4.5 m	
The flue termination is no less than 1000 mm from the roof surface	
There is adequate venting in the room in accordance with AS/NZS 5601.1	
Safe draining is installed where condensation is likely to accumulate	

2.8 PERFORMANCE TEST TO VERIFY SYSTEM FUNCTIONALITY

When the "Start" button is pressed, the incineration cycle will be activated. The estimated incineration time for the verification test is approximately 60 - 70 minutes. The yellow light will be lit when the incineration is ongoing, and the complete test should be completed without any fault indications or system interruptions. The toilet will have to cool down to the point that the fan has stopped before the ash container can be removed. The cooling phase can take from 30 - 60 minutes, depending on the ambient cooling temperature.

The end result should only be fine white dust. Any end results deviating from this or an incineration time exceeding 80 minutes may indicate a restriction in the flue vent or a lack of oxygen. Check that the installation is in accordance with the specifications in section 2.5.

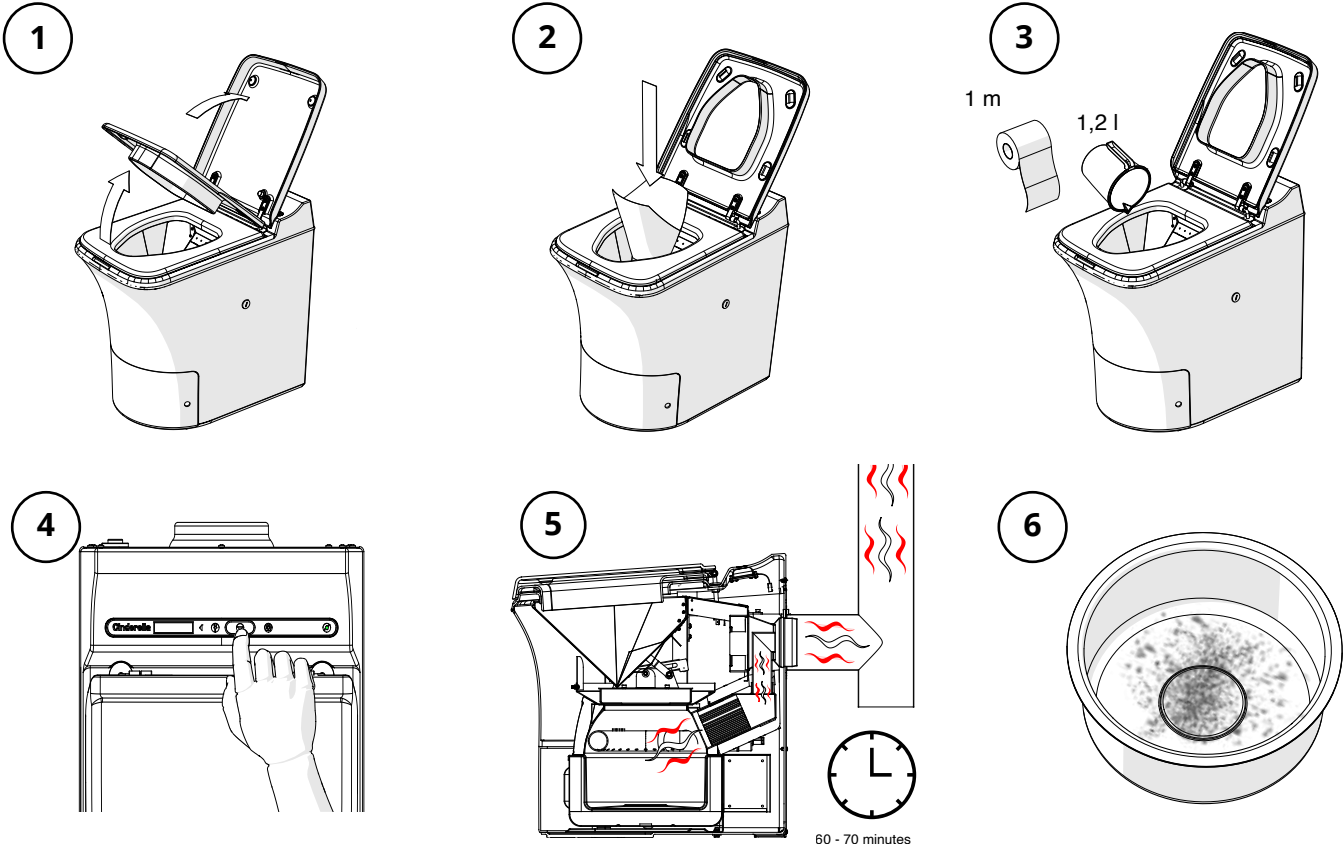

CAUTION!

The ash container will get very hot while incinerating. Do not remove the front lid until the toilet has cooled completely and the fan has stopped.

3. USER SECTION

3.1 INTENDED USE AND HANDLING

The Cinderella Freedom toilet is intended for indoor installation and use in residential homes, second homes, outhouses, site welfare units, boathouses, pool houses and cabins.

The toilet is solely designed to burn bodily waste products and small sanitary products such as toilet paper, sanitary pads and baby, face and cleaning wipes. Using the Cinderella Freedom to burn other items constitutes misuse and will void your warranty.

DO NOT PUT THE FOLLOWING ITEMS INTO THE TOILET

- Excessive amounts of paper of any kind
- Newspaper
- Paper towels
- Flammable liquids or materials
- Cigarette lighters
- Cigarettes or cigars
- Petrol
- Alcoholic drinks or liquors
- Alcohol or rubbing alcohol
- Nail polish remover
- Lighter fluid
- Lamp oil / kerosene
- Aerosol containers
- Glass or plastic bottles or containers etc.

HOW TO HANDLE THE WASTE



DO NOT THROW IN TOILET



3.2 GENERAL SAFETY



WARNING!

- Do not operate the incineration toilet if it is visibly damaged.
- If the connection cable for the toilet is damaged, it must be replaced by the manufacturer, customer service or a similarly qualified person in order to prevent safety hazards.
- This incineration toilet may only be repaired by qualified personnel. Unauthorised repairs can result in considerable danger or damage to the toilet.
- Cleaning and user maintenance may not be carried out by unsupervised children.
- Do not use any explosive substances or flammable cleaning agents, such as spray cans with propellants when cleaning the toilet.



NB!

- The toilet is solely designed to burn bodily waste products and small sanitary products such as tampons, sanitary pads and baby, face and cleaning wipes.
- Young children must be supervised when they use Cinderella incineration toilets.

3.3 SAFETY WHEN OPERATING WITH GAS



WARNING!

- Never use an unshielded flame to check gas-bearing parts and pipes for leakage, as this presents a risk of fire or explosion.
- In case of gas odour:
 - Close the gas supply stopcock and the valve on the cylinder.
 - Open all windows and leave the room.
 - Do not turn any electrical switches on or off.
 - Put out any naked flames.
 - Have the gas system checked by a specialist.

3.4 SAFE OPERATIONS



CAUTION!

- The ash container in the toilet will become very hot when the toilet is in use. Make sure the safety cover is in place when the toilet is in use. Do not empty the ash container until the toilet has cooled completely.
- The seat and lid do not have a soft-close function. Take care not to crush your hands or fingers when closing the lid and seat.



NB!

Danger of poor incineration and overheating of the system!

- Always use a new bowl liner when using the toilet.
- Always ensure sufficient ventilation so that the heat generated during the operation can dissipate.

3.5 CINDERELLA FREEDOM SAFETY FEATURES

- The incineration process is inactive while the toilet lid is open. The incineration will not start until the seat and lid are closed.
- The hatch to the incineration chamber CANNOT remain open while the toilet is still hot (e.g. during cleaning). This is only possible when the toilet has cooled down and the fan has stopped.
- Should a ventilation problem arise and the internal temperature of the toilet increases to more than 105 °C, incineration will be interrupted and a warning message displayed. This situation requires a manual reset to ensure the ventilation issue is addressed before the toilet can be used again.
- If the ash container is improperly positioned after emptying, incineration will not start and a warning light and message will be displayed.
- If the combustion chamber hatch mechanism gets jammed or is prevented from closing properly, incineration will not start and an error message will be displayed.
- The Cinderella Freedom's smart software includes a "watchdog" function that monitors the temperature while incineration is taking place. If any deviations from the normal temperature range are detected, this will immediately result in the incineration stopping and a warning message being displayed.

3.6 IMPORTANT USER INFORMATION



NOTE!

- Always remember to place a new liner in the toilet bowl before use, one liner per person, per visit
- The toilet lid must always be closed when the toilet is not in use. Incineration will not start or continue until the lid has been closed.
- The incineration cycle could take up to 180 minutes from the most recent visit.
- The fan will continue to run until incineration is completed and the internal temperature of the toilet has returned to the normal range. Cooling can take up to 120 minutes after incineration is completed, depending on the temperature of the air provided for cooling.
- Your Cinderella toilet may be used at any point during the incineration or cooling processes. Incineration is interrupted during use. Be sure to close the lid and press "Start" at the completion of each visit.

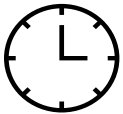

1 hour

Capacity: 4 persons

The Cinderella Freedom is designed to handle up to four visits per hour. To avoid overload, more than six visits per hour is not recommended. Overloading the toilet with many visits in a short period of time, without completing an incineration cycle, can result in odours and leakage, and may damage the toilet.



Empty

Emptying Frequency

The total liquid capacity of the system's waste container is 5 L. The ash container should be emptied frequently (once a week) for best operation. This ensures more efficient incineration and helps keep the catalytic converter cleaner.

If your ash container has not been removed (by weekly emptying routines), your Cinderella Freedom will display a message to empty the container after 90 incineration cycles, and will lock out further visits if not emptied after 120 visits. We recommend that you empty the toilet as often as possible to ensure better incineration efficiency and less wear of the product.

Failing to empty the ash container when full may cause damage to the toilet and void your warranty.



Long period

Preparing your toilet for a lengthy period of non-use

In cases of longer periods of non-use, the waste must be incinerated, and the ash container emptied.



Max 4 visits

Short period of increased use

Should the situation require an unusually high number of guests to use the toilet for a short period of time, please follow these tips:

1. Empty the ash container completely before guests arrive.
2. Preheat the toilet before use by opening and closing the lid then pressing the Start button.
3. Ensure guests are instructed to use a bowl liner and press "Start" after every visit.
4. Check regularly to ensure the toilet lid is closed and the yellow incineration light is still lit.
5. You may need to run an extra incineration cycle or two before emptying the ash container to ensure that the waste has been fully incinerated.

3.7 THE CONTROL PANEL

The control panel is equipped with a combination of light, sound and display messages that will give the best possible user experience. There are a number of light and sound combinations that will tell the user about the status of the system. It is important that all users familiarise themselves thoroughly with these signals before use. An overview of all the light and sound signals can be found in the troubleshooting table in section 5.1.



NOTE!

- A green light indicates that the toilet is connected to the power supply. When only the green light is lit, the toilet is in standby and ready for use.
- A yellow light indicates an ongoing incineration process and will light constantly while the toilet is in incineration mode
- A red light indicates interruption and will alert the user that the toilet is no longer incinerating or in standby.

Standby

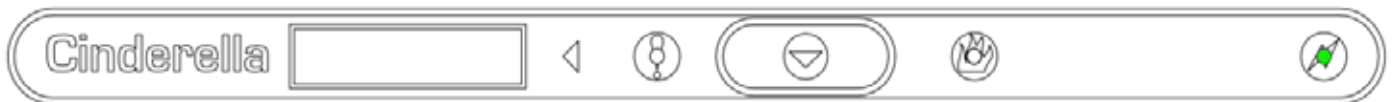

Incineration mode

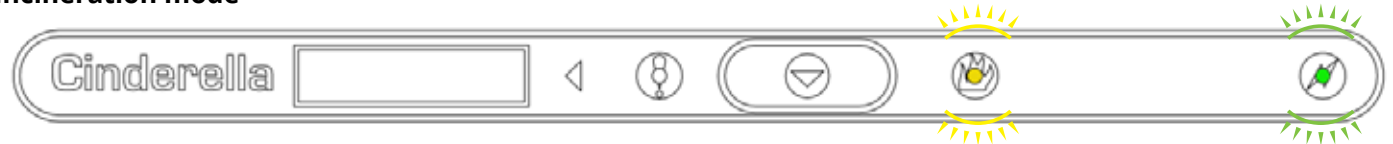

System interrupted

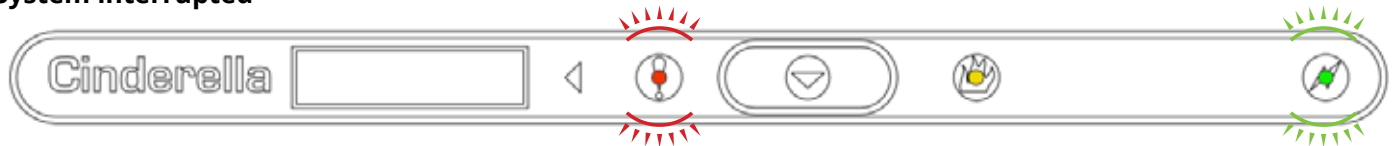

Selecting your language

Hold down the "Select language" button for three seconds until "Language" is displayed on the first text line. The current language will be displayed on the second line. Push the "Select language" button repeatedly until the desired language is displayed. The new language will be saved a few seconds after you press the button, and the toilet will resume operation.

Language select button

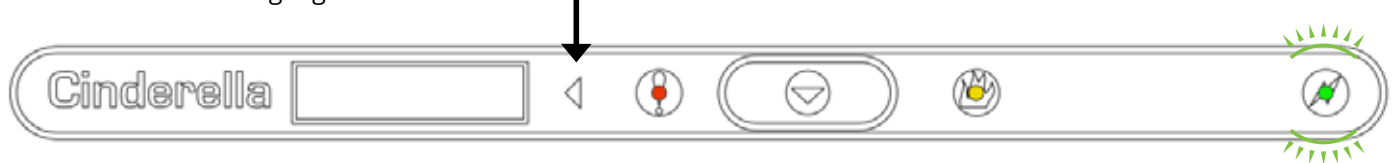

Emptying indicator

Your Cinderella Freedom will indicate when it is time to empty the ash container. The display will read "EMPTY THE ASH CONTAINER" and you will hear three short beeps when the toilet lid is opened. If not emptied within a certain amount of uses, the toilet will lock down. At this point the yellow, red and green lights are constantly lit and the display will read "TOILET LOCKED CONTAINER FULL". You will hear three short beeps every ten seconds until the ash container is emptied.

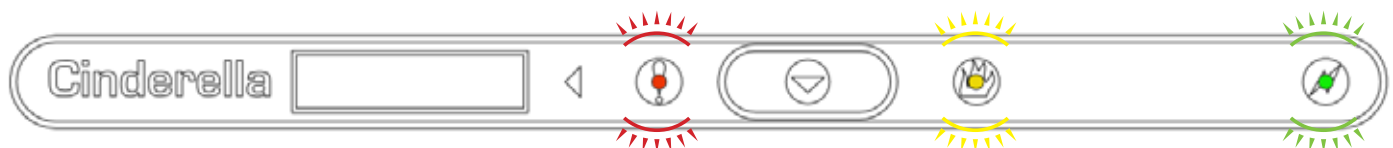

3.8 USING THE CINDERELLA FREEDOM TOILET

1

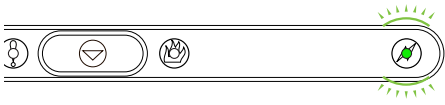

1. Check that the green light on the control panel is lit, indicating the unit is powered and ready for use.

2

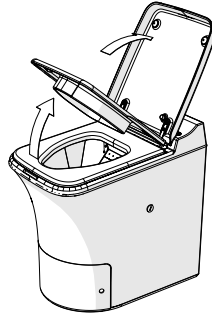

2. Lift the toilet lid and seat. A red light starts flashing. The ventilation fan starts.

3

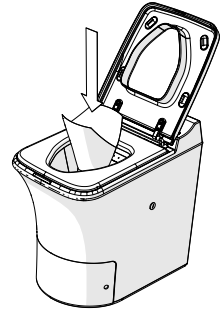

3. Place a bowl liner in the bowl. Use a new bowl liner for every visit.

4

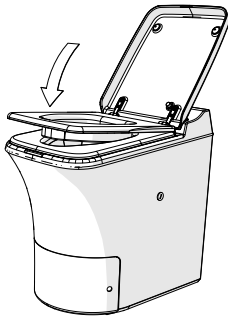

4. Lower the seat. The toilet is ready for use.

5

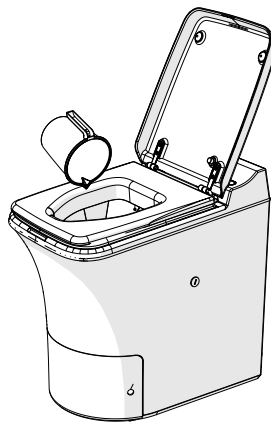

5. Use the toilet as usual. If little waste is produced, it may be helpful to pour some water into the bowl to add weight.

6

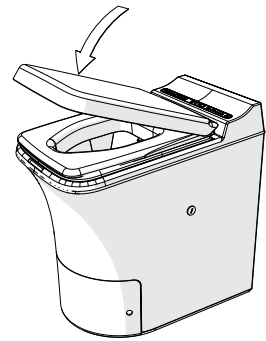

6. Close the toilet lid.

7

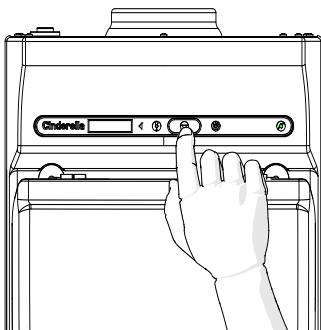

7. Push the "Start" button to drop the bowl liner and its contents into the incineration chamber. Incineration begins as soon as the hatch is closed. The toilet is now ready for the next user.

8

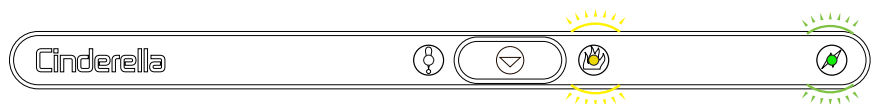

8. A constant yellow light will display during active incineration. The toilet may be used at any point. This will temporarily interrupt incineration. Incineration time may vary based on the number of visits and amount of waste.

3.9 OPERATING THE FRONT COVER AND ASH CONTAINER



CAUTION!

Only operate the ash container when the toilet is in sufficiently cooled and in standby mode.



NOTE!

Please see the maintenance section for instructions regarding cleaning and emptying the ash container.

1

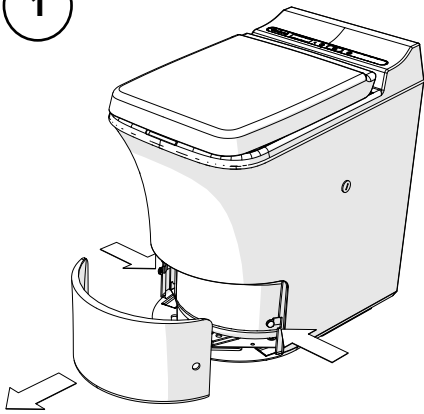

2

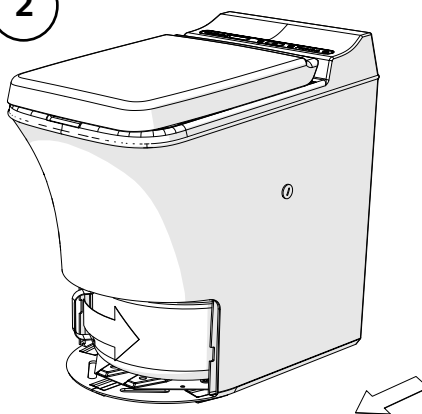

3

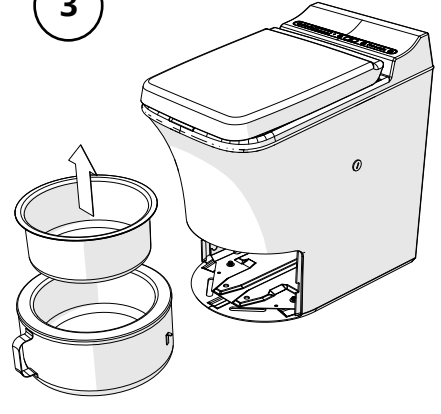

4

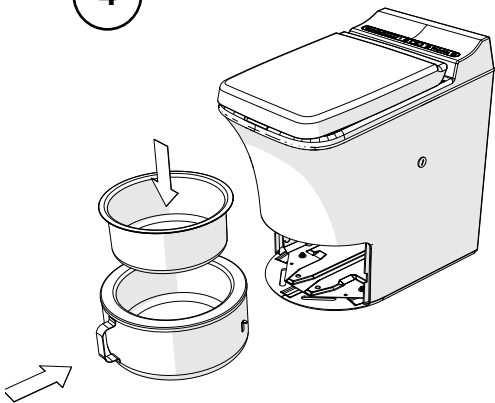

5

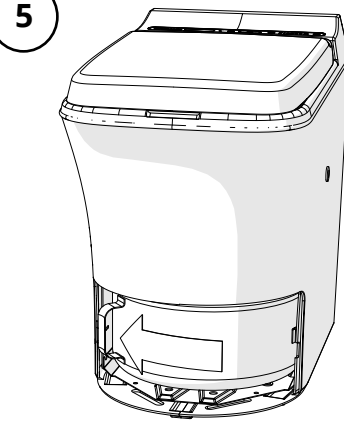

6

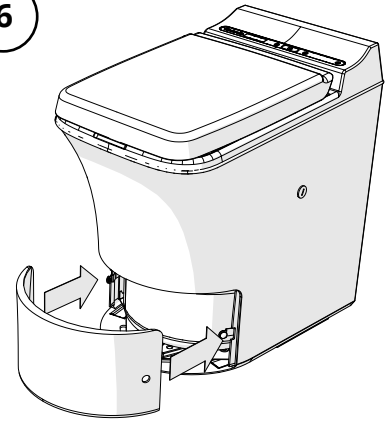

3.10 APPLIANCE ORIENTATION

ID	PART DESCRIPTION
1	Control panel w/display
2	Lid
3	Seat
4	Ash container with insert
5	Front cover
6	Stop pin
7	Temperature safety

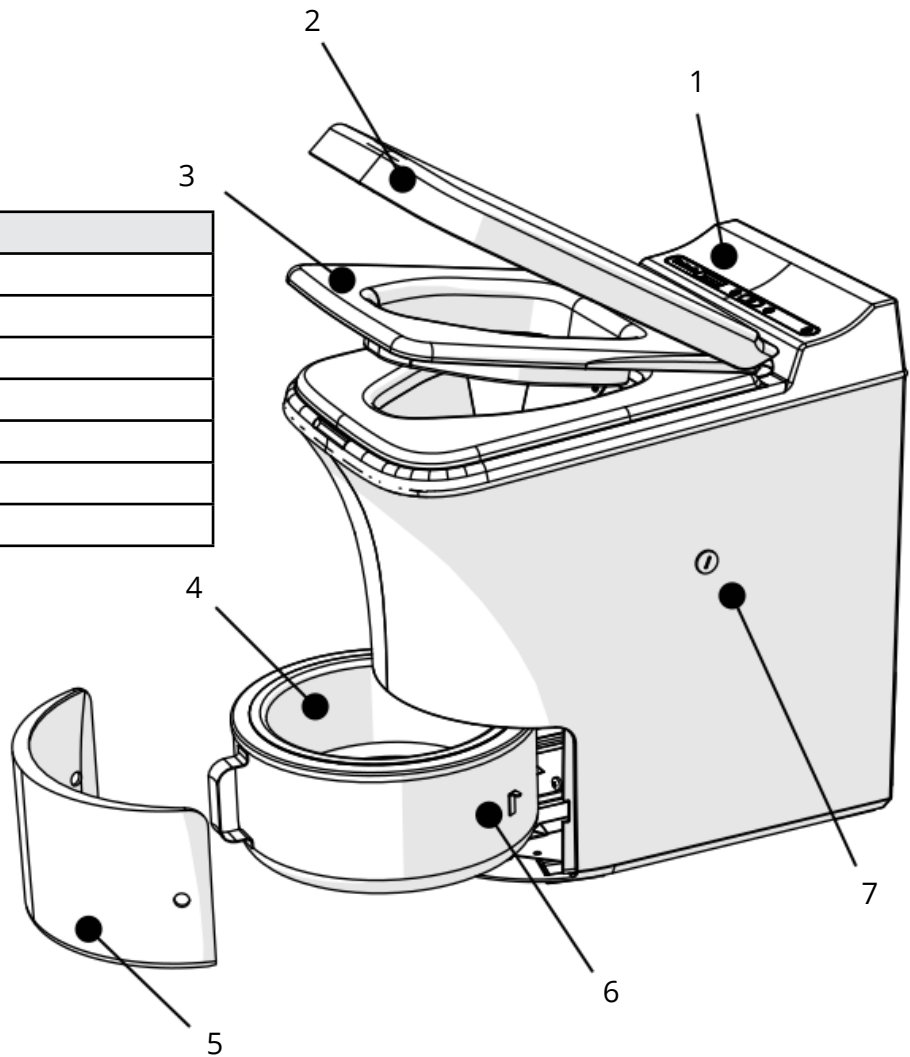

4. GENERAL MAINTENANCE INSTRUCTIONS

This manual includes both customer maintenance and the maintenance to be performed by professionals in accordance with the necessary expertise and authorisations.

A smooth-running air circulation system is critical to keep your toilet functioning properly. Particles generated during the incineration process can clog the catalyst and exhaust pipe over time, and it is important to regularly maintain these parts to ensure proper functionality.

In order to ensure optimal operation and extend the lifetime of your Cinderella Freedom appliance you will need to set aside a little time for preventive maintenance. Good maintenance routines will give you lower operating costs and cause less wear on the product. We strongly advise our customers to perform frequent maintenance as follows:

1. Empty the toilet frequently. Do not base your use on the maximum limit of the appliance.
2. Always clean the ash container and insert when emptied (see section 4.2.1).
3. Always perform the steam cleaning after each box of bowl liners (500 uses) (see section 4.2.2).
4. Always observe the end result characteristics when emptying the toilet. Deviations in the end result may indicate the need for maintenance or service (see section 4.1).



CAUTION!

Before performing maintenance, always make sure that the toilet is not in incineration mode and that the toilet is sufficiently cooled.

4.1 END PRODUCT CHARACTERISTICS

The residual waste, or “ashes”, will consist of pathological residue, salts and minerals, and will therefore often be perceived as hard and crystallised. There should be no visible signs of paper or flaky layers of unburned waste, the ashes should be a combination of white and dark shade of grey. If there are larger deposits of black unburned waste, humidity or paper when emptying the toilet, please start an additional incineration without inserting paper or water. When the incineration is completed, empty the ash container and perform the maintenance procedures as instructed in this manual.

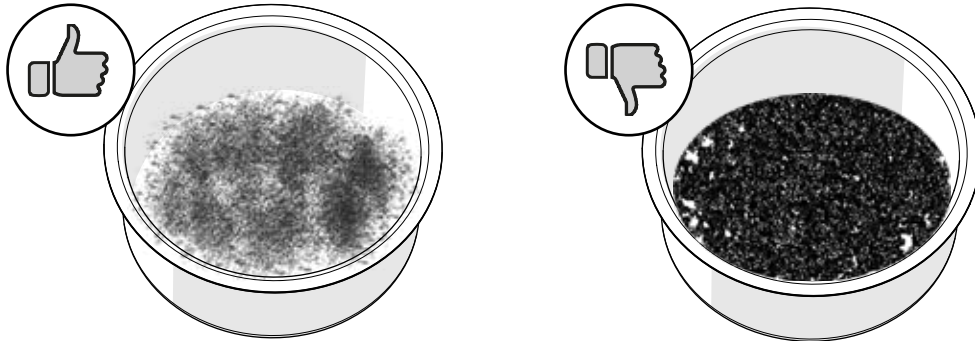

NB!

- The ash is not suitable to use as fertiliser or compost. It should be disposed of in your household waste in accordance with relevant public regulations.
- The remaining ash is sterile and safe to handle when it has burned to a light colour. If the ash is black and flaky or the incineration cycle was incomplete, run an extra incineration cycle to ensure that the ash has been fully incinerated. If the problem persists, see the troubleshooting section for further advice.

4.2 CUSTOMER MAINTENANCE

4.2.1 EMPTYING AND CLEANING THE ASH CONTAINER

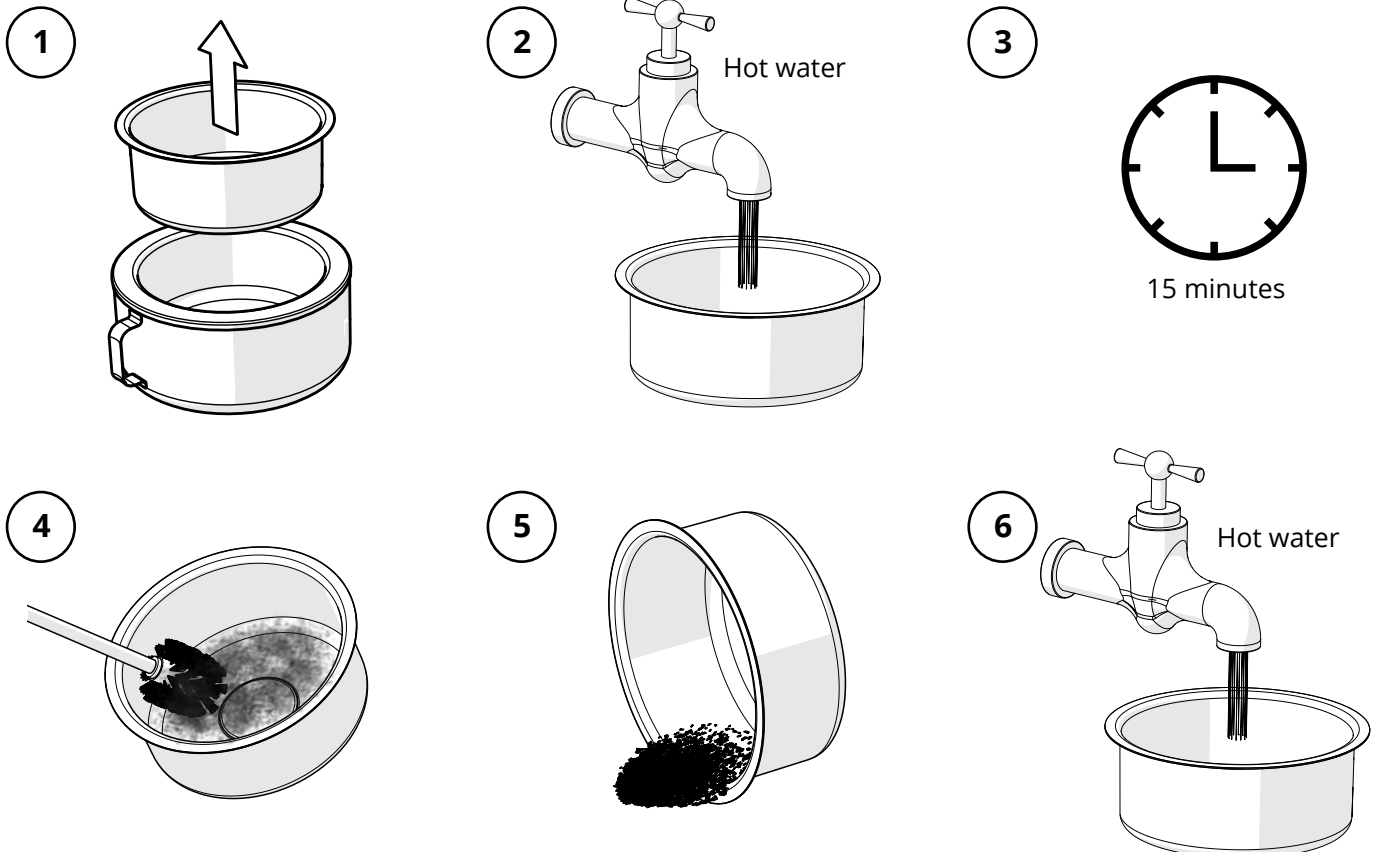

7

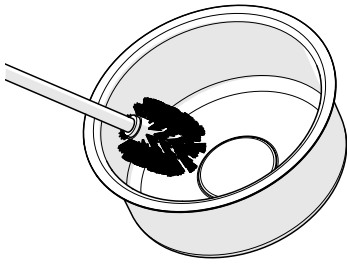

8

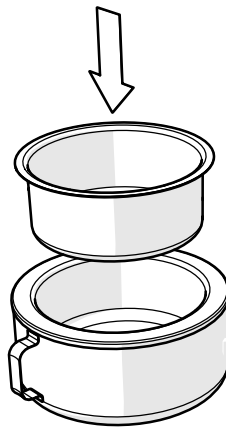

NOTE!

Make sure to dry the external part of the insert before reinserting it into the ash container



NB!

- Do not use any sharp tools or objects when cleaning the ash container insert, as this will damage the insert and reduce its service life.
- Make sure to dry the external part of the insert before reinserting it into the ash container



NOTE!

In order to preserve the functionality of the toilet in the best possible way, we recommend that you carry out the "steam cleaning" procedure in accordance with section 4.2.2 every time you empty and wash the insert. This will prevent the possible accumulation of tar and unwanted deposits in the catalytic converter and toilet exhaust system.

4.2.2 STEAM-CLEANING THE CATALYTIC CONVERTER

Recommended frequency: weekly or when emptying the ash container. To perform steam cleaning:

1. Ensure that the toilet is cold and the ash container has been emptied and cleaned (see section 4.2.1).
2. Remove the front cover and release the ash container .
3. Pour approximately 1 L of clean water into the toilet insert.
4. Insert the ash container carefully without spilling any water, and attach the front cover.
5. Lift the lid and verify that the fan starts spinning.
6. Press "Start" to begin an incineration cycle.
7. The water will start to boil and the steam will clean the exhaust system. This system cleaning will normally take 60-70 minutes.

1



2

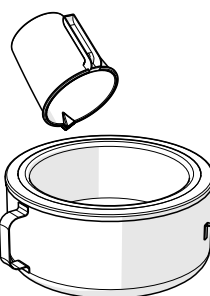

3

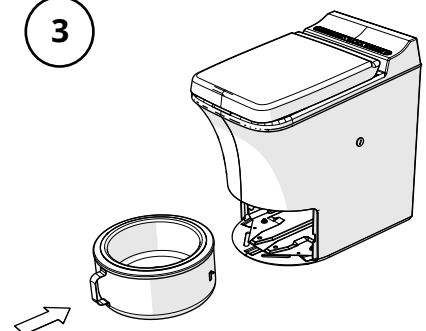

4

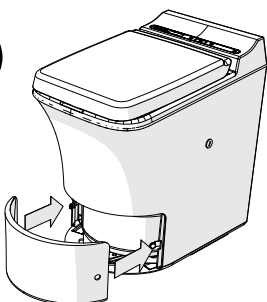

5

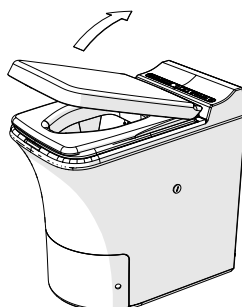

6

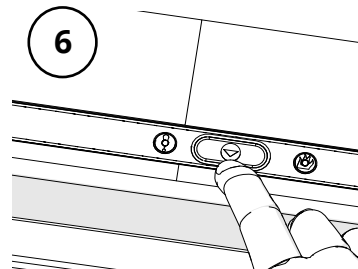

7

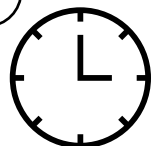

60-80 minutes

**NOTE!**

Do not use the toilet during the maintenance procedure, as this will impair the function of the cleaning. The toilet can be used when the toilet returns to standby mode.

4.2.3 INSPECTING THE CATALYTIC CONVERTER

The catalyst is the primary air duct between the incineration chamber and the appliance flue terminal. Any accumulations of particles in the catalytic converter will reduce the flow rate and the toilet efficiency. It is therefore important to ensure that the catalytic converter is open at all times. Any changes in incineration time and/or incineration efficiency may be due to dense catalytic conversion. The best method to easily clean the catalyst is to perform “steam cleaning” as described in section 4.2.2. You can also inspect the front of the catalyst by removing the ash container and illuminating the combustion chamber from the inside. Any particles and accumulations can be removed using a vacuum cleaner.

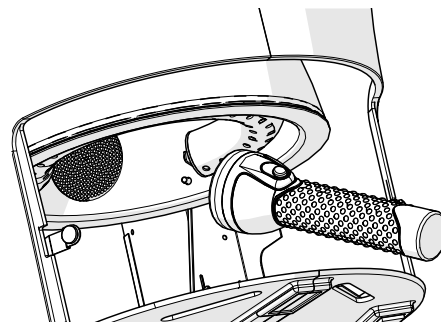
**NOTE!**

Clear signs of corrosion or deformity of the catalytic converter will indicate that the catalytic converter must be replaced. Contact your local service provider to arrange for service.

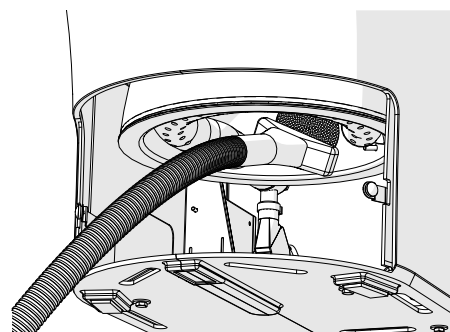
**4.2.4 CLEANING THE BOWL**

Recommended frequency: as required for cleanliness and when emptying the ash container.

To clean the bowl:

1. Open the toilet lid.
2. Press and hold the Start button for three seconds to open the hatch to the washing position.
3. Use moist paper, water and a mild cleaning agent as required. Close the lid and start the incineration

1

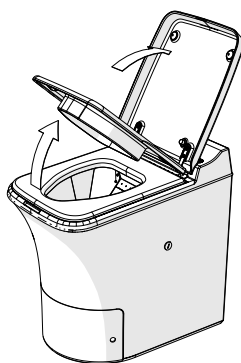

2

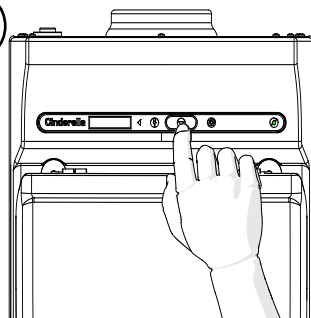

3

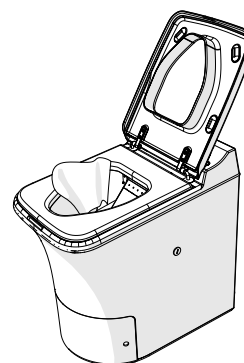
**WARNING!**

Do not use flammable cleaning agents to clean the bowl. Make sure that the toilet is cooled and in standby mode.

**CAUTION!**

Some metal edges may be sharp

**NB!**

Do not use chlorine-based cleaning agents to clean the bowl. Chlorine is extremely harmful for the catalytic converter and if put into the toilet it may cause the catalyst to malfunction.

4.2.5 MAINTENANCE OF DURAVENT FLUE PIPE SYSTEM

1. An annual inspection is required to maintain warranty of your DuraVent B Vent system. You will need to inspect the cap, flue pipe, connector pipe, and the connection to the appliance.
2. Verify that the sealant around the flashing and storm collar is intact. Reseal as needed. Remove the cap. Hold Cap by the collar only, unlock by twisting anticlockwise, and then pull up. Grasping the cap by the outer edge or top can damage it.
3. Inspect the cap for any physical damage or damage from corrosion. Look for any foreign material inside the cap or vent. e.g. bird's nest, leaves, etc.).
4. Shine a light down inside the flue pipe. Look for any evidence of damage, corrosion or excessive condensation. Also, look for any disconnected sections of the flue pipe or connector pipe. Refer to the installation instructions to reconnect pipe sections. If pipe sections are damaged or corroded, replace immediately!
5. Replace the cap by grasping it (by the collar only) and sliding it onto the pipe section and twist-locking (clockwise).
6. Inspect the appliance connector and make sure that the vent is securely connected to the appliance.
7. Damaged or corroded parts should be replaced immediately. Failure to do so can lead to an extremely hazardous situation.

4.3 PROFESSIONAL MAINTENANCE



CAUTION!

Professional maintenance will require the toilet to be disconnected from the flue pipe. In some areas, only professional qualified gas personnel may be permitted to do this. It is therefore important to ensure that all maintenance is performed in accordance with all state, municipal and local codes, and AS/NZS 5601.1.



NOTE!

Before disconnecting the appliance and rinsing the system with hot water, inspect the catalytic converter and perform steam cleaning in accordance with section 4.2.2. If the catalytic converter is still clogged, or odour is still noticeable when incinerating, perform the system rinsing in accordance with section 4.3.1

4.3.1 RINSING THE EXHAUST SYSTEM AND CATALYTIC CONVERTER

Recommended frequency: at least every 500 uses.

1. The appliance will have to be disconnected from the flue pipe, fixed gas pipe, power source and docking station. To improve the access you may remove the ventilation adaptor before proceeding with the cleaning.
2. Clean the exhaust pipe with a flexible brush. Use your finger to check that the exhaust pipe is clean.
3. Remove the ash container and clean out the debris from the exhaust pipe (appliance flue terminal).
4. Use a vacuum cleaner to extract the remaining debris in the exhaust pipe and catalytic converter
5. Place the toilet where it is OK to spill water, e.g. where there is a suitable drain, outside or in a bath. Use the specially designed Cinderella funnel, or a funnel that fits in the exhaust pipe. Slightly tilt the toilet forward, and pour 2-3 L of hot water through the exhaust pipe and catalyst. The excess water should be clean at the end of the rinsing process. If necessary, use more water to properly clean the system.
6. Repeat step 1 4-5 times until the water is clean and no crystals or other obstructions can be spotted when inspecting the catalyst (see section 4.2.3)
7. Reconnect the appliance to the flue pipe, docking station, gas and power supply.
8. Install the ash container and front cover.
9. Open and close the lid to simulate the use of the appliance. With the lid closed push the button to start the incineration. This will dry out the system and prepare the toilet for reuse.

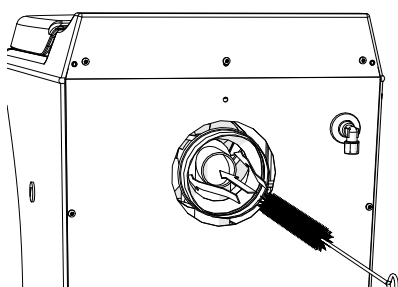

Clean exhaust and venturi

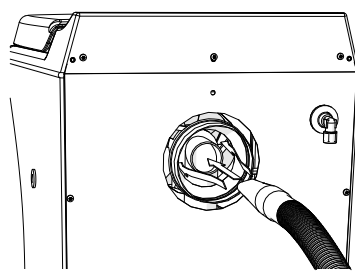

Vacuum exhaust and venturi

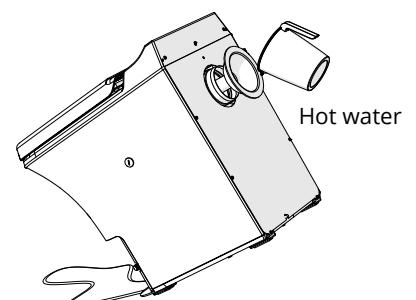

Rinse the catalytic converter

**CAUTION!**

The front of the outer shell is thin and should therefore not carry the entire weight of the toilet. Be gentle while tilting the appliance and make sure that the toilet is placed in such a position that the toilet shell is safeguarded. It is advised to be two people to do this operation, where one can hold the toilet while the other rinses the catalytic converter

5. TROUBLESHOOTING AND FAQ

**CAUTION!**

All troubleshooting and servicing that requires the toilet to be disconnected from the flue pipe or gas line must be performed in accordance with all state, municipal and local codes. If you are unsure of the regulations in your area, please contact your nearest dealer or service representative for further instructions. The power should be disconnected when performing all servicing and maintenance on the toilet.

Out of gas

Failure to incinerate properly and a flashing yellow display lamp may indicate that the propane tank is empty and must be refilled or replaced.

Resetting the toilet system

During cleaning and troubleshooting, resetting the electronics may sometimes be helpful. You can do this by pressing the "Start" button. This will cause a short beep to sound. Hold down the button for about eight seconds until you hear a long beep, then release the button.

Error messages

When lights are flashing, you should look for the reason, and fix the problem before using the toilet. You must take immediate action in the event of any irregularities such as odours, poor incineration or system failures, in order to avoid damage and unnecessary repair costs.

Triggered bi metal thermostat

The bi metal thermostat is triggered if the internal temperature in the toilet is too high. This will normally occur if there is a lack of air flow, or fresh air into the room where the toilet is installed. It is therefore important that you check that the intake air is in accordance with the specifications, and that the flue vent is open and free of obstacles. Visually check the catalytic converter and perform the steam cleaning procedure in accordance with section 4.2.2.

During a power outage

If an incineration process is ongoing during a power outage, you may experience temporary odours from inside the toilet and smoke and odours from the flue pipe outside. With loss of power, the fan will stop, which may result in the toilet exterior becoming slightly warmer. Since the incineration will not automatically restart when the mains power returns, you must manually restart the toilet in order to start a new incineration cycle. If the power outage is expected to last for longer than two hours, it is important that you empty any waste from the toilet, as this could damage the toilet if it remains there for a longer period of time. Never use the toilet during a power outage.

Odours in the room

Odours can have several causes:

1. Failure to use a bowl liner each time the toilet is used or improper use of the liner.
2. The airflow may be blocked. Inspect the flue pipe and flue termination cap.
3. Check that the installation has been performed in accordance with the installation manual. Too much restriction in the flue pipe could cause back pressure and cause odours inside.
4. The exhaust pipe may be clogged. See section 4.3.1.
5. The catalyst may be clogged. See section 4.3.1.

Odours outside

The causes may be the same as for inside the room, or:

1. The catalyst has not reached operational temperature. When the toilet is cold it can take a few minutes before the catalyst reaches the temperature where it starts to function properly.
2. The catalyst may be corroded or deformed (see section 4.2.3). Contact your servicing provider.

5.1 TROUBLESHOOTING TABLE

ERROR	DISPLAY MESSAGE	RED LIGHT	YELLOW LIGHT	GREEN LIGHT	SOUND	ACTIONS
Ash container should be emptied	Empty the ash container	FLASHING Alternately	FLASHING Alternately	STEADY ON	3 BEEPS	1 Remove and empty the ash container * Toilet must be connected to 230V.
Ash container must be emptied. Toilet locked.	Toilet locked container full	STEADY ON	STEADY ON	STEADY ON	3 BEEPS 10 SECONDS APART	1 Remove and empty the ash container * Toilet must be connected to 230V.
No power		OFF	OFF	OFF		1 Make sure that the toilet is connected to power, min 11.5 V
Ventilation fan error	Error fan	FLASHING	OFF	FLASHING	10 BEEPS	1 Check fan for obstructions and ensure that fan blades are rotating properly Reset toilet (hold down "Start") 2 Open lid until red light flashes, close lid and press "Start". If error persists, call support
Burner fan error	Error burner fan	FLASHING	FLASHING	FLASHING	10 BEEPS	1 Check fan for obstructions and ensure that fan blades are rotating properly Reset toilet (hold down "Start") 2 Open lid until red light flashes, close lid and press "Start". If error persists, call support
Malfunctioning hatch mechanism	Error hatch mechanism	FLASHING	OFF	STEADY ON	10 BEEPS	1 If toilet is warm, reset toilet 2 Open lid until red light flashes, close lid and press "Start" 3 If unsuccessful, reset toilet, insert a bowl liner and pour 3 cups of water into the liner, close lid and press "Start" 4 If unsuccessful wait until the toilet has cooled (fan stopped) Restart toilet and open lid when the hatch is opening, remove stuck items manually. If problem persists, call support
Ash container out of position	Ash container is out of position	FLASHING	FLASHING	STEADY ON	3 BEEPS	1 Adjust the position of the ash container, rotate the handle to the left side 2 Check that the stop pin on the container is intact 3 Visually check the condition of the magnet on the container. If problem persists, call support
Heating circuit interrupted	Error burner system	OFF	FLASHING	STEADY ON	CONTINUOUS BEEPS	1 Reset the toilet and wait 15 minutes. 2 Check that there is gas 3 Check bimetal thermostat on right-hand-side of toilet. Unscrew grey plug and push on fuse inside with finger: do not use any sharp objects If the fuse was triggered, you will hear a click. See section 5. 4 If the fuse was not the problem, restart toilet and try to start toilet. Repeat a couple of times. If problem persists, call support
Toilet lid sensor is triggered	Lid is open	FLASHING	OFF	STEADY ON	NONE	1 Check the magnet situated inside the toilet lid and close lid. If problem persists, call support.
Malfunctioning temperature sensor	Error temp sensor	OFF	FLASHING	FLASHING	CONTINUOUS BEEPS	1 Reset toilet 2 Open lid until red light flashes, close lid and press "Start" 3 If failure persists, call support
Unreadable / no display message	Unreadable / blank screen					1 Unplug toilet and wait 5 minutes 2 Plug in toilet and restart toilet 3 If problem persists, call support

6. REPAIRS AND SPARE PARTS



CAUTION!

All service requiring the toilet to be disconnected from the flue pipe and/or gas supply should be performed in accordance with all state, municipal and local codes, and AS/NZS 5601.1.

6.1 SPARE PARTS LIST

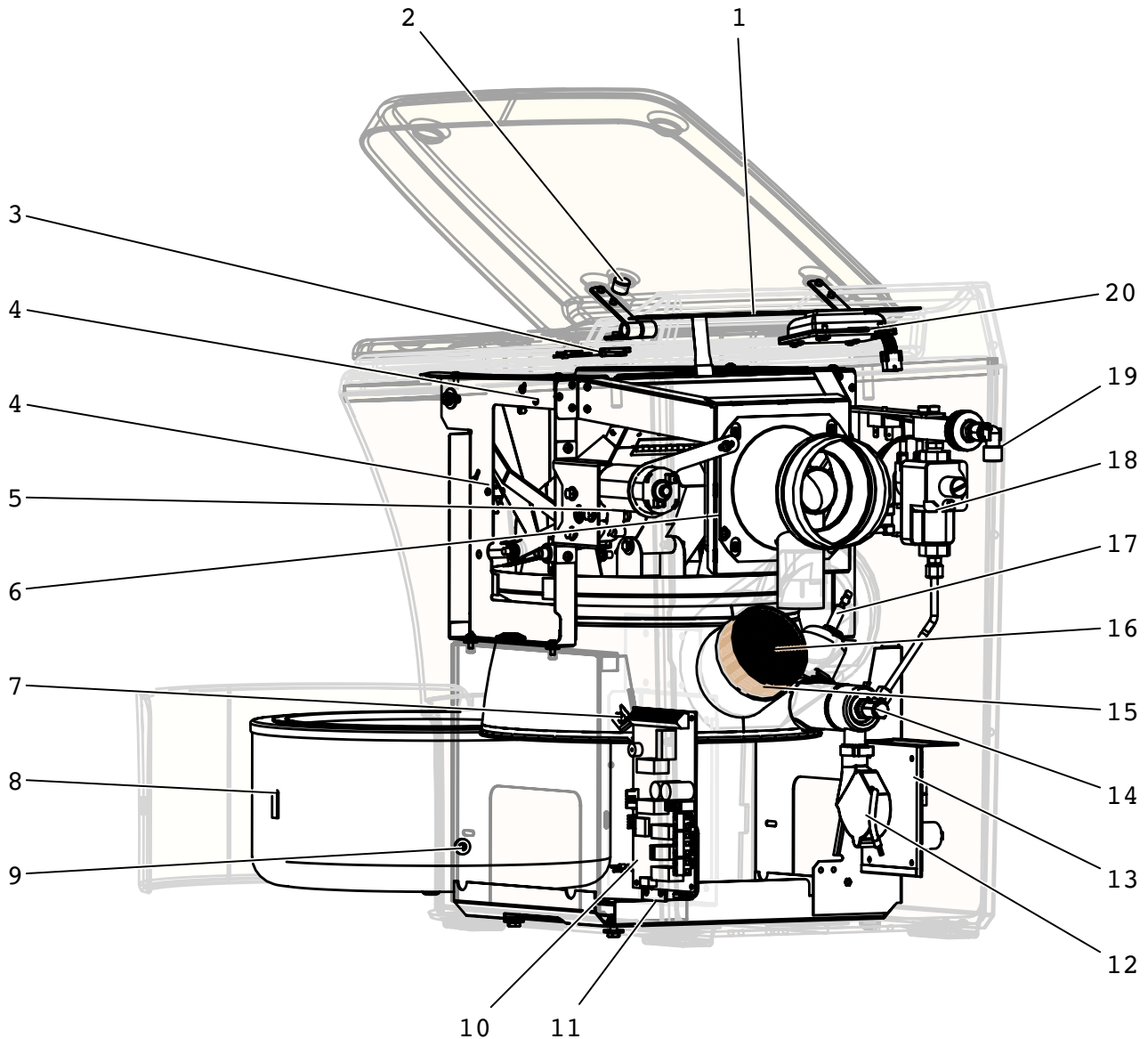

ID	PART DESCRIPTION	ART. NO
1	Control panel	100981
2	Magnet 14x10mm	100433
3	Hall sensor w/ wire and tape L= 330mm	100964
4	Micro switch	101127
5	Motor Nidec 12/24VDC	101177
6	Fan axial 12VDC 119x38mm	100154
7	Thermocouple assembly	100831
8	Stop bracket 9x26x12mm	100017
9	Magnet 14x7mm	100065
10	Circuit board gas	100989

ID	PART DESCRIPTION	ART. NO
11	Hall sensor	100228
12	Fan centrifugal 51x51x15	100542
13	Ignition unit Fenwal	100424
14	Gas nozzle 8 inches WC propane SM	101414
15	Insulation fabric 275x90x2mm	100163
16	Catalytic converter 90x75mm	100528
17	Ignition electrode	100196
18	Gas control - Maxitrol CV200	101224
19	Elbow ¼" BSP to ½" BSP	101754
20	Display LED 65 x 36 x 13	100401

6.2 APPLIANCE PROCESS OVERVIEW

The Cinderella appliance is designed according to fail-safe principles. In the event of component failure or faulty control signals, the toilet will go into "safety mode". This means that the unit will not be able to start an incineration and error messages will appear on the display, ensuring that all component and/ or signal failures that may occur are safeguarded in the system.

The appliance is equipped with hall sensors that control both the lid and ash container. These sensors are normally open and will be triggered when in contact with the magnet(s) mounted on the outside of the container and inside the toilet lid.

When the lid is opened, the axial fan will start to ventilate the system. After each use, the incineration is activated by pressing the button on the control panel. The bowl liner with its waste contents is dropped from the toilet bowl into the incineration chamber, where it is safely incinerated at a high temperature.

The hatch mechanism is controlled by two microswitches, one mounted on the top of the toilet frame to check that the hatch is in the desired "open" position, and one mounted on the lower front end of the appliance ensuring that the hatch is in safe, enclosed position.

The gas system is controlled by an internal gas controller and is safeguarded with an advanced dual-solenoid shut-off valve with an integrated pressure regulator. The ignition system is operated by the internal ignition controller and the ignition electrode functions both as an igniter and flame fault. The ignition electrode will monitor the flame and safeguard any disturbances or deviations inside the burner.

During incineration, the air supplied into the room provides the oxygen required for proper Incineration. The exhaust vent removes excess heat. All fumes and vapours are processed through a heat-activated platinum catalyst to reduce emissions and odours.

The temperature inside the incineration chamber is closely monitored by the thermocouple mounted inside the chamber, the temperature inside the toilet is safeguarded by the bimetal thermostat mounted on the interior frame of the toilet.

The incineration process can take 40 – 180 minutes and is controlled automatically by the appliance's sensory technology. The toilet can be used at any time while incinerating. The incinerating process will be paused when the lid is opened and automatically reactivated when lid is closed. Numerous safeguards exist to ensure safe operation. See section 3.5 of this manual.

6.3 TECHNICAL ORIENTATION

ID	PART DESCRIPTION
1	Axial fan
2	Liner placed in bowl
3	Burner tube
4	Ash container
5	Hall sensor
6	Thermocouple
7	Inlet air
8	Catalytic converter
9	Outlet air

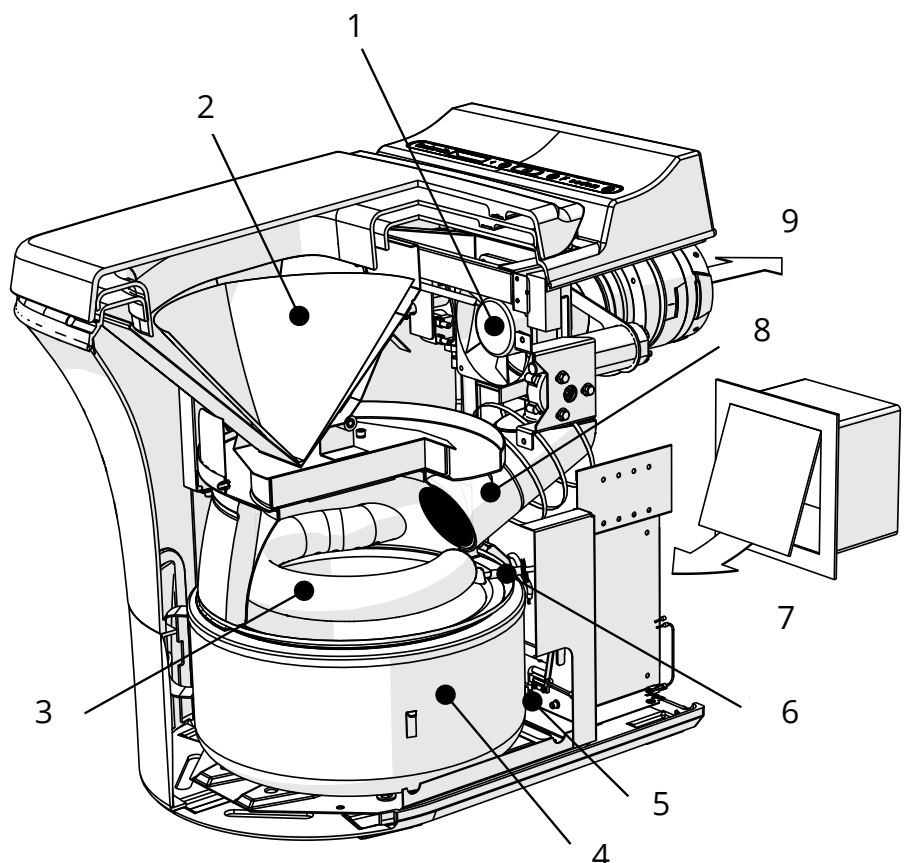

6.4 WIRING DIAGRAM

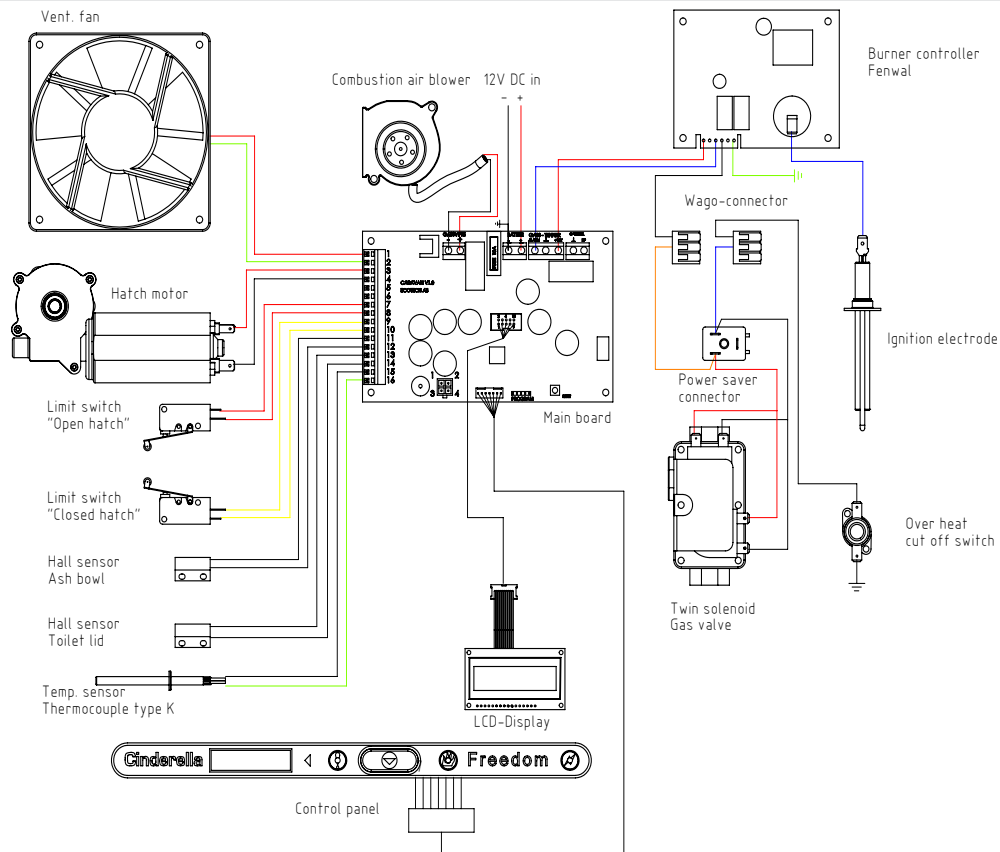

7. WARRANTY

What does this Warranty cover?

This warranty covers defects in materials or workmanship in your Cinderella incineration toilet on the terms, for the period and subject to the exceptions set out below.

What does this Warranty not cover?

This warranty does not include on-site service call outs and does not cover normal wear and tear or damage caused by accidents (including fire, floods, hurricanes or acts of nature), abuse, misuse, failure to follow manufacturer directions or improper maintenance. Consequential and incidental damages are not recoverable under this warranty. Some states do not allow the exclusion or limitation of incidental or consequential damages, so the above limitation or exclusion may not apply to you.

How long does the Warranty apply?

This warranty lasts for a period of three (3) years from the original date of purchase.

What will Cinderella Eco Australia do?

If you submit a valid claim under this warranty, Cinderella Eco Australia will either repair, replace or refund the purchase price of your Cinderella incineration toilet, at its sole discretion.

How do I arrange a service?

To arrange a service, call Cinderella Eco Australia or visit an Authorised Service Provider. Available service options are dependent on the country in which service is requested and may be restricted to the original state in which the sale took place. Call charges and shipping charges may apply, depending on the location.

You may be required to furnish proof-of-purchase details when making a claim under this warranty. For further warranty information please refer to our web page: www.cinderellaeco.com

How does state law apply?

This warranty gives you specific legal rights, and you may also have other rights which vary from state to state. Please check your local laws.

Cinderella Eco Australia Pty Ltd

GPO Box 1797, Sydney 2001, Sydney, New South Wales 2000, E-mail: sales.australia@cinderellaeco.com



Cinderella[®]
Cinderella Eco Group

CINDERELLA'S GLOBAL PRESENCE

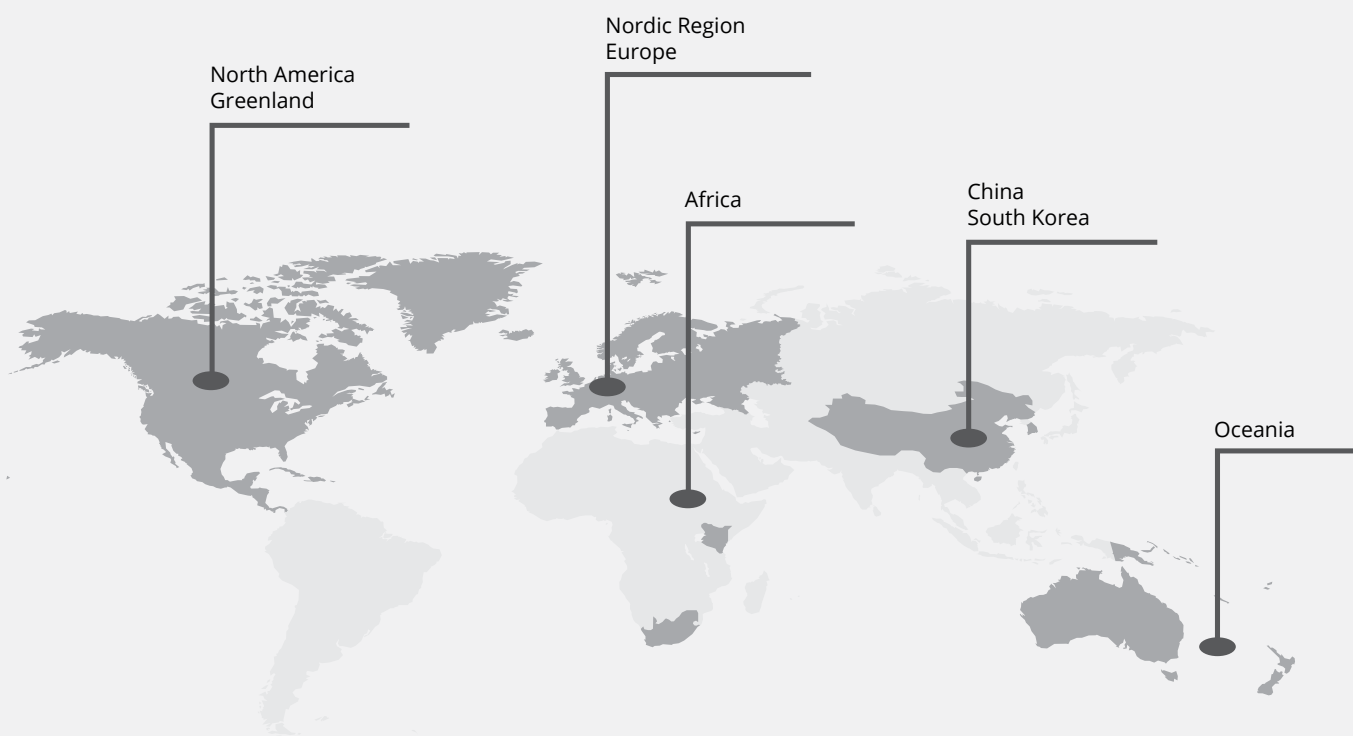

Cinderella Eco Group AS
Sjøvikvegen 67, NO-6475 Midsund, Norway
www.cinderellaeco.com